

February 07, 2025

Attention: Tim Hart
ALBERTA STRAINERS LTD.
9577 - 60 AVENUE
EDMONTON, AB T6E 0C2

The design submission, Tracking Number 2025-00160, Web Portal Number 2025-S0074, originally received on January 09, 2025 was surveyed and accepted for registration as follows:

CRN : 0E15199.2

Accepted on: February 07, 2025

Reg Type: RENEWAL

Expiry Date: February 07, 2035

Drawing No. : Table 1 Scope of Fitting Designs

Fitting type: Y & B Strainers

Design registered in the name of : FLOW LINK SYSTEMS (P) LTD

The registration is conditional on your compliance with the following notes:

As indicated on AB-41 Statutory Declaration or AB-351 Declaration of Conformity form and submitted documentation, the code of construction is B16.34.

- It is our understanding that the fitting(s), included as the scope of this submission, that is(are) subject to the Safety Codes Act shall comply with the requirements of the indicated Standard or Code of Construction on the AB-41 Statutory Declaration or AB-351 Declaration of Conformity as supported by the attached data which identifies the dimensions, materials of construction, press./temp. ratings and the basis for such ratings, and the identification marking of the fittings.*
- This registration is valid only for fittings fabricated at the location(s) covered by the QC certificate attached to the accepted AB-41 Statutory Declaration or AB-351 Declaration of Conformity form.*
- This registration is valid only until the indicated expiry date and only if the Manufacturer maintains a valid quality management system approved by an acceptable third-party agency, and maintains a valid Certification of Authorization Permit if required by the jurisdiction where manufacturing takes place, until that date.*
- Should the approval of the quality management system lapse before the expiry date indicated above, this registration shall become void.*

An invoice covering survey and registration fees will be forwarded from our Revenue Accounts.

If you have any question don't hesitate to contact me by phone at (587) 686-9349 or fax (780) 437-7787 or e-mail Wangi@absa.ca.

Sincerely,



WANG, IAN, P. Eng.
DOP Cert. No. D00009643

**STATUTORY DECLARATION
Registration of Fittings**
Single or Multiple Fitting Designs within one Fitting Category

I, J.PARTHIBAN : DIRECTOR-OPERATIONS
(name of applicant) (position title) (must be in a position of authority)
of FLOW LINK SYSTEMS (P) LTD
(name of manufacturer)
located at 189/1A-C, UTHUPALAYM, ARASUR, COIMBATORE-641 407, INDIA
(plant address)

In this space, show facsimile of manufacturer's logo or trademark as it will appear on the fitting.

ALTA

do solemnly declare that the fittings listed hereunder, which are subject to the Safety Codes Act (select only one)

- ☐ comply with the requirements of _____ which specifies the dimensions,
(title of recognized North American Standard)
materials of construction, pressure/temperature ratings and identification marking of the fittings, or
- ☒ are not covered by the provisions of a recognized North American standard and are therefore
manufactured to comply with ASME B16.34 & B16.5 as supported by the
(title of code of construction or other applicable document)
attached data which identifies the dimensions, materials of construction, pressure/temperature ratings and the basis for such ratings, and the identification marking of the fittings.

I further declare that the manufacture of these fittings is controlled by a quality control program which has been verified as described in the below Table as being suitable for the manufacturing of these fittings to the stated standard, regulation, code, guideline or other applicable document. The fittings covered by the declaration for which I seek registration are as provided in the Supplementary Sheet(s) attached.

Quality Program Verification and Manufacturing Sites

A copy of the Quality Certificate from each manufacturing site must be included

Item #	Product Description, Model or Series	Quality Program	Scope of Certification	Expiry Date	Verifying Organization	Location(s) Plant Name and address
1.	STRAINERS	ISO 9001:2015	DESIGN MFG & SUPPLY OF FORGED/	2027-08-02	TUV NORD	FLOW LINK SYSTEMS (P) LTD, 641 407
2.	STRAINERS	ISO 9001:2015	CAST & STRAINERS	2027-08-02	TUV NORD	FLOW LINK SYSTEMS (P) LTD, 641 407

In support of this application, the following information, calculations and/or test data are attached:

SEE ATTACHED - ATTACHMENT "B" STRAINER LIST AND CATALOGUES

(Signature of the Declarer)

30 Dec 2024
(Date)

DECLARED before me at COIMBATORE in the STATE of TAMIL NADU
(city) (province, territory, or state)
this 30 day of DEC, 2024
(Month) (Year)

(print) K.K. NATESAN
(a Commissioner of Oaths or Notary Public)

(sign) 
(a Commissioner of Oaths or Notary Public)

My Commission Expires
on 21st August 2027
(expiry date (mm/dd/yyyy))

K.K. NATESAN, B.Com., B.L.,
ADVOCATE & NOTARY PUBLIC
Coimbatore District
7, Jawans Bhavan, Ground Floor,
COIMBATORE - 641 018.
Mob: 94437 10112, 63816 06230
(province, territory, or state)

Commissioner of Oaths / Notary Public in and for: _____

For ABSA Office Use Only:

NOTES: _____

To the best of my knowledge and belief, the application
meets the requirements of the Safety Codes Act and CSA
Standard B51, Part 1, Clause 4.2, and is accepted for
registration in Category E.

CRN: _____

Registered Date: Feb 7, 2025

Expiry Date: Feb 7, 2035

Signature: _____
(Signature of the Administrator/SCO)

The information you provide is necessary only for the administration of the
programs as required by the Alberta Safety Codes Act and Regulations in the
Pressure Equipment Discipline

2025-00160

ABSA

SAFETY CODES ACT - PROVINCE OF ALBERTA

ACCEPTED: OE15199. 2

**See acceptance letter for
conditions of registration.**

Date: **2025-02-07**

By: 

IAN WANG, P. Eng.
DOP: D00009643

This stamp and signature have been affixed electronically
to this registered design as required by Section 20(1) of
the Pressure Equipment Safety Regulation, in accordance
with the Electronic Transactions Act.

Table 1 Scope of Fitting Designs

Item #	Primary Pressure Bearing / Retaining component	Material of Construction	Port connections and Size Range	MDMT	Rated pressure		Pressure Class(es) / Schedule(s)	Design code(s) of Construction	Reference Catalogue Page(s) or Drawing(s)
					At Ambient Temperature	At Maximum Temperature			
Y-STRAINER 2025-00160	BODY & CAP	ASTM A351 Gr. CF8M A352 Gr. LCC A216 Gr. WCB A216 Gr. WCC	FLANGED ENDS NPS 2 - 10	-20°F	AS PER ASME B16.34	AS PER ASME B16.34	CLASS 150 NPS 2 - 8	ASME B16.34	CATALOGUE MODEL NYF 150 SS MODEL NYF 150 LCC MODEL NYF 150
							CLASS 300 NPS 2 - 10		CATALOGUE MODEL NYF 300 SS MODEL NYF 300 LCC MODEL NYF 300
							CLASS 600 NPS 2 - 8		CATALOGUE MODEL NYF 600 SS MODEL NYF 600 LCC MODEL NYF 600
							CLASS 900 NPS 2 - 8		CATALOGUE MODEL NYF 900 SS MODEL NYF 900 LCC MODEL NYF 900
							CLASS 1500 NPS 2 - 4		CATALOGUE MODEL NYF 1500 SS MODEL NYF 1500 LCC MODEL NYF 1500
Y-STRAINER	BODY & CAP	ASTM A351 Gr. CF8M A352 Gr. LCC A216 Gr. WCB A216 Gr. WCC	SCREWED END SOCKET WELD NPS 1 1/2 - 2	-20°F	AS PER ASME B16.34	AS PER ASME B16.34	CLASS 2500 NPS 2 - 3	ASME B16.34	CATALOGUE MODEL YF 2500 LCC MODEL YF 2500
							CLASS 600 NPS 1 1/2 - 2		CATALOGUE MODEL NYS 600 SS MODEL NYS 600 LCC MODEL NYS 600
							CLASS 1500 NPS 1 1/2 - 2		CATALOGUE MODEL YS 1500 SS MODEL YS 1500 LCC MODEL YS 1500
Y-STRAINER	BODY & CAP	ASTM A182 Gr. F316 A352 Gr. LF2 A105N	SCREWED END SOCKET WELD NPS 1/2-1	-20°F	3000PSI @ -20°F TO 100°F	2425 PSI @ 500°F	3000 PSI	ASME B16.34	CATALOGUE MODEL YS3000SS MODEL YS3000 LF2 MODEL YS3000
B-STRAINER	BODY & CAP	ASTM A351 Gr. CF8M A352 Gr. LCC A216 Gr. WCB A216 Gr. WCC	FLANGED ENDS NPS 2 - 8	-20°F	AS PER ASME B16.34	AS PER ASME B16.34	CLASS 150 NPS 2 - 8	ASME B16.34	CATALOGUE MODEL BFS 150 MODEL BFS 150 LCC MODEL BFS 150 SS
							CLASS 300 NPS 2		CATALOGUE MODEL BFS 300 MODEL BFS 300 LCC MODEL BFS 300 SS
							CLASS 600 NPS 2 - 4		CATALOGUE MODEL BFS 600 MODEL BFS 300 LCC MODEL BFS 300 SS

ABSA
SAFETY CODES ACT - PROVINCE OF ALBERTA
ACCEPTED: 0E15199. 2
See acceptance letter for
conditions of registration.
Date: 2025-02-07 By: 
IAN WANG, P. Eng.
DOP: D00009643

This stamp and signature have been affixed electronically to this registered design as required by Section 20(1) of the Pressure Equipment Safety Regulation, in accordance with the Electronic Transactions Act.



FLOW LINK SYSTEMS PRIVATE LIMITED

Email: hr.flowlink@voith.com Web: www.flowlinksystems.com
Certified to ISO 9001:2015, API-6D, ISO 14001:2015, ISO 45001:2018, EN 15085, ISO 3834, PED, IIR
CIN No: U29120TZ1992PTC003779 GST No: 33AAACF3239K1Z5

VOITH

ATTACHMENT "B"

VALVES & MODELS

SL. NO.	SPECIFICATION		
	MODEL #	GAD / CATALOGUE	
1	NYF150	CATALOGUE MODEL NYF150	Y-STRAINER-FLANGED END
2	NYF300	CATALOGUE MODEL NYF300	Y-STRAINER-FLANGED END
3	YF600	CATALOGUE MODEL YF600	Y-STRAINER-FLANGED END
4	YF1500	CATALOGUE MODEL YF1500	Y-STRAINER-FLANGED END
5	YF2500	CATALOGUE MODEL YF2500	Y-STRAINER-FLANGED END
6	NYS600	CATALOGUE MODEL NYS600	Y-STRAINER-TE & SW END
7	YS1500	CATALOGUE MODEL YS1500	Y-STRAINER-TE & SW END
8	YS2500	CATALOGUE MODEL YS2500	Y-STRAINER-TE & SW END
9	YS3000	CATALOGUE MODEL YS3000	Y-STRAINER-TE & SW END
10	BFS150	CATALOGUE MODEL BFS150	B-STRAINER-FLANGED END
11	BFS300	CATALOGUE MODEL BFS300	B-STRAINER-FLANGED END
12	BFS600	CATALOGUE MODEL BFS600	B-STRAINER-FLANGED END

Manufactured By,

Flow Link Systems (P) Ltd.,
189/1A-1C Uthupalayam, Arasur,
Coimbatore-641 407,
India.

A VOITH GROUP COMPANY

Regd. Office Address:

189/1A-C, Uthupalayam, Avanashi Road, Arasur, Coimbatore - 641 407. INDIA
Telephone: +91-422-2360913 Mobile: +91 98947 90830

2025-00160

ALTA	MODEL BFS 150 150# ANSI CARBON STEEL RAISED FACE FLANGED BASKET STRAINER	DRAWING A53
-------------	---	--------------------

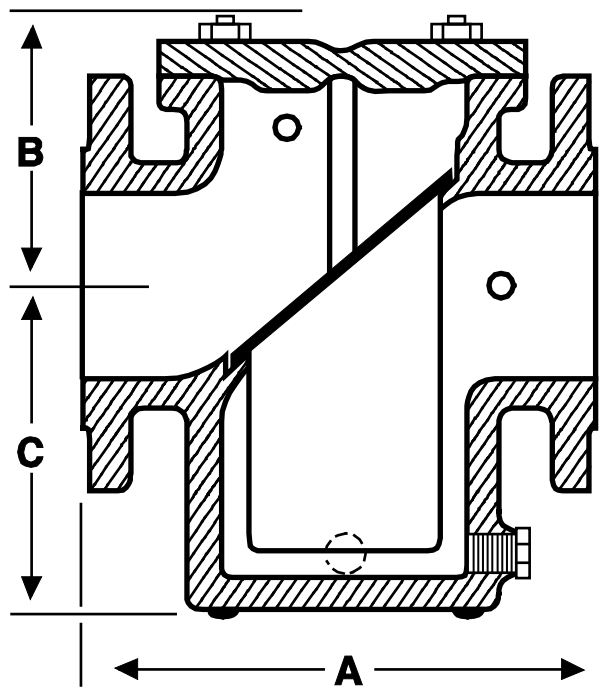

DESCRIPTION	MATERIAL
BODY	ASTM A 216 GR. WCB
COVER	ASTM A 216 GR. WCB
STUD	ASTM A 193 GR. B7
NUT	ASTM A 194 GR. 2H
GASKET	NON ASBESTOS
BASKET	304 SS 1/8 PERF

TEMPERATURE		WORKING PRESSURE	
C	F	kPa	P.S.I.
-29 to 38	-20 to 100	1965	285
95	200	1790	260
150	300	1585	230
200	400	1380	200
260	500	1170	170

NOTE 2" TO 4" DRAIN IS ON SIDE

FLANGES ARE IN ACCORDANCE WITH ANSI B16.5

ALL STRAINERS ARE INDIVIDUALLY HYDROSTATICALLY TESTED TO ANSI B16.5

SIZE		DIMENSIONS						DRAIN	GUAGE CONN		NET WEIGHT		
		A		B		C							
mm	in.	mm	in.	mm	in.	mm	in.	mm	in.	mm	in.	Kg	Lbs
50	2	206	8 1/8	127	5	115	4 9/16	25	1	15	1/2	14.5	32
80	3	225	8 7/8	146	5 3/4	146	5 3/4	25	1	15	1/2	20.9	46
100	4	285	11 1/4	158	6 1/4	209	8 1/4	25	1	15	1/2	35.4	78
150	6	352	13 7/8	177	7	317	12 1/2	40	1 1/2	15	1/2	68	150
200	8	441	17 3/8	215	8 1/2	406	16	40	1 1/2	15	1/2	110	242
250	10	549	21 5/8	273	10 3/4	445	17 1/2	40	1 1/2	15	1/2	161	355
300	12	635	25	317	12 1/2	558	22	40	1 1/2	15	1/2	280	615

BOTTOM OF COVER IS CONVEX SO THAT LIQUID LEVEL IS BELOW TOP OF BODY.
THIS WILL HELP PREVENT SPILLAGE WHEN BASKET IS REMOVED.

ALTA	MODEL BFS 300 300# ANSI CARBON STEEL RAISED FACE FLANGED BASKET STRAINER	DRAWING A56
-------------	---	--------------------

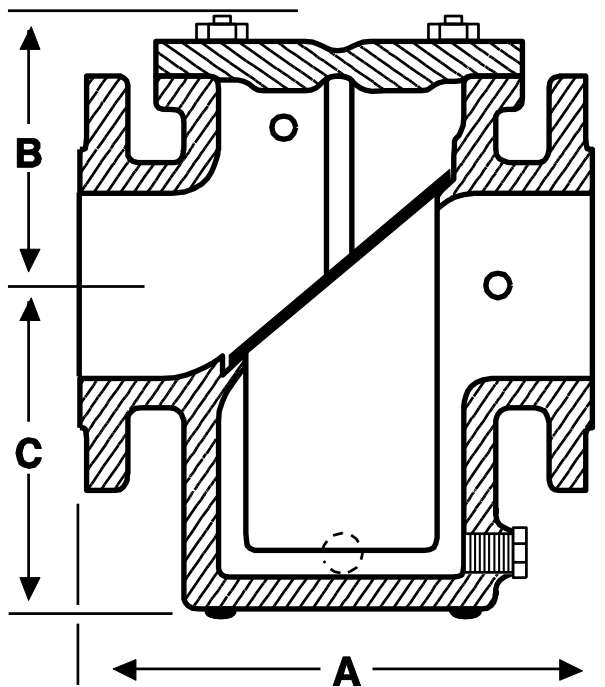

DESCRIPTION	MATERIAL
BODY	ASTM A 216 GR. WCB
COVER	ASTM A 216 GR. WCB
STUD	ASTM A 193 GR. B7
NUT	ASTM A 194 GR. 2H
GASKET	NON ASBESTOS
BASKET	304 SS 1/8 PERF

TEMPERATURE		WORKING PRESSURE	
C	F	kPa	P.S.I.
-29 to 38	-20 to 100	5100	740
95	200	4655	675
150	300	4515	655
200	400	4380	635
260	500	4135	600

NOTE 2" TO 4" DRAIN IS ON SIDE

FLANGES ARE IN ACCORDANCE WITH ANSI B16.5

ALL STRAINERS ARE INDIVIDUALLY HYDROSTATICALLY TESTED TO ANSI B16.5

SIZE		DIMENSIONS						DRAIN		GUAGE CONN		NET WEIGHT	
		A		B		C							
mm	in.	mm	in.	mm	in.	mm	in.	mm	in.	mm	in.	Kg	Lbs
50	2	222	8 3/4	152	6	114	4 1/2	25	1	15	1/2	19.5	43
80	3	242	9 9/16	152	6	139	5 1/2	25	1	15	1/2	28.6	63
100	4	298	11 3/4	177	7	203	8	25	1	15	1/2	48.6	107
150	6	374	14 3/4	196	7 3/4	323	12 3/4	40	1 1/2	15	1/2	95	210
200	8	460	18 1/8	216	9 1/4	384	15 1/8	40	1 1/2	15	1/2	143	315

BOTTOM OF COVER IS CONVEX SO THAT LIQUID LEVEL IS BELOW TOP OF BODY.
THIS WILL HELP PREVENT SPILLAGE WHEN BASKET IS REMOVED.

ALTA	MODEL BFS 600 600# ANSI CARBON STEEL RAISED FACE FLANGED BASKET STRAINER	DRAWING A93
-------------	---	--------------------

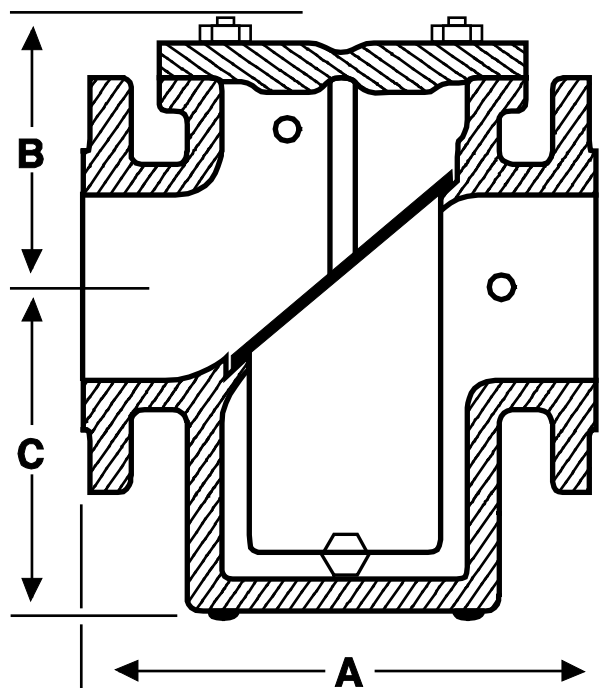

DESCRIPTION	MATERIAL
BODY	ASTM A 216 GR. WCB
COVER	ASTM A 216 GR. WCB
STUD	ASTM A 193 GR. B7
NUT	ASTM A 194 GR. 2H
GASKET	SPIRAL WOUND SS
BASKET	304 SS 1/8 PERF

TEMPERATURE		WORKING PRESSURE	
C	F	kPa	P.S.I.
-29 to 38	-20 to 100	10200	1480
95	200	9300	1350
150	300	9060	1315
200	400	8750	1270
260	500	8275	1200

FLANGES ARE IN ACCORDANCE WITH ANSI B16.5

ALL STRAINERS ARE INDIVIDUALLY HYDROSTATICALLY TESTED TO ANSI B16.5

SIZE		DIMENSIONS						DRAIN		GUAGE CONN		NET WEIGHT	
		A		B		C							
mm	in.	mm	in.	mm	in.	mm	in.	mm	in.	mm	in.	Kg	Lbs
25	2	254	10	165	6 1/2	117	4 5/8	25	1	15	1/2	21	47
80	3	320	12 5/8	215	8 1/2	152	6	25	1	15	1/2	43	95
100	4	383	15 1/16	210	8 1/4	200	7 7/8	25	1	15	1/2	79	175

BOTTOM OF COVER IS CONVEX SO THAT LIQUID LEVEL IS BELOW TOP OF BODY.
THIS WILL HELP PREVENT SPILLAGE WHEN BASKET IS REMOVED.

ALTA	MODEL BFS 150 LCC 150# ANSI CARBON STEEL RAISED FACE FLANGED LOW TEMP BASKET STRAINER	DRAWING L91
-------------	--	--------------------

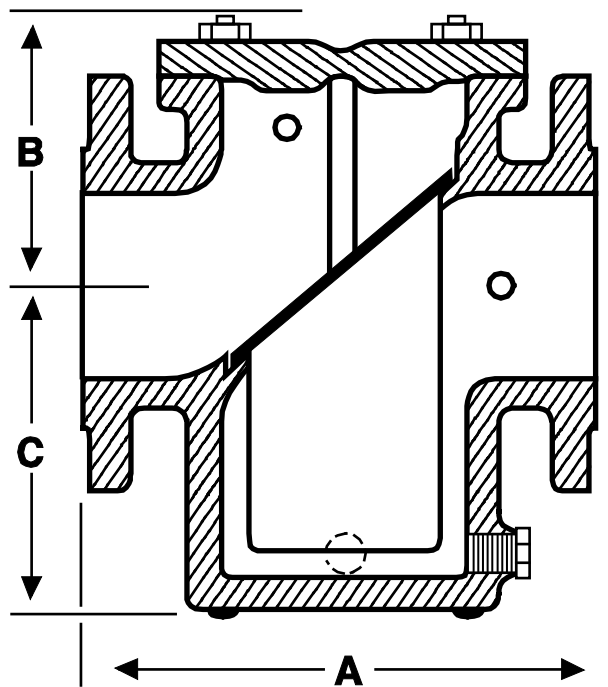

DESCRIPTION	MATERIAL
BODY	ASTM A352 GR. LCC
COVER	ASTM A352 GR. LCC
STUD	ASTM A320 GR. L7M
NUT	ASTM A194 GR. L7M
GASKET	NON ASBESTOS
BASKET	304 SS 1/8 PERF

TEMPERATURE		WORKING PRESSURE	
C	F	kPa	P.S.I.
-45 to 38	-50 to 100	1980	290
95	200	1788	260
150	300	1582	230
200	400	1376	200
260	500	1169	170

NOTE 2" TO 4" DRAIN IS ON SIDE

FLANGES ARE IN ACCORDANCE WITH ANSI B16.5

ALL STRAINERS ARE INDIVIDUALLY HYDROSTATICALLY TESTED TO ANSI B16.5

SIZE		DIMENSIONS						DRAIN	GUAGE CONN		NET WEIGHT		
		A		B		C							
mm	in.	mm	in.	mm	in.	mm	in.	mm	in.	mm	in.	Kg	Lbs
50	2	203	8 1/8	127	5	115	4 9/16	25	1	15	1/2	14.5	32
80	3	225	8 7/8	146	5 3/4	146	5 3/4	25	1	15	1/2	20.9	46
100	4	285	11 1/4	158	6 1/4	209	8 1/4	25	1	15	1/2	35.4	78
150	6	352	13 7/8	177	7	317	12 1/2	40	1 1/2	15	1/2	68	150
200	8	441	17 3/8	215	8 1/2	406	16	40	1 1/2	15	1/2	110	242
250	10	549	21 5/8	273	10 3/4	445	17 1/2	40	1 1/2	15	1/2	161	355
300	12	635	25	317	12 1/2	558	22	40	1 1/2	15	1/2	280	615

BOTTOM OF COVER IS CONVEX SO THAT LIQUID LEVEL IS BELOW TOP OF BODY.
THIS WILL HELP PREVENT SPILLAGE WHEN BASKET IS REMOVED.

ALTA	MODEL BFS 300 LCC 300# ANSI CARBON STEEL RAISED FACE FLANGED LOW TEMP BASKET STRAINER	DRAWING L92
-------------	--	--------------------

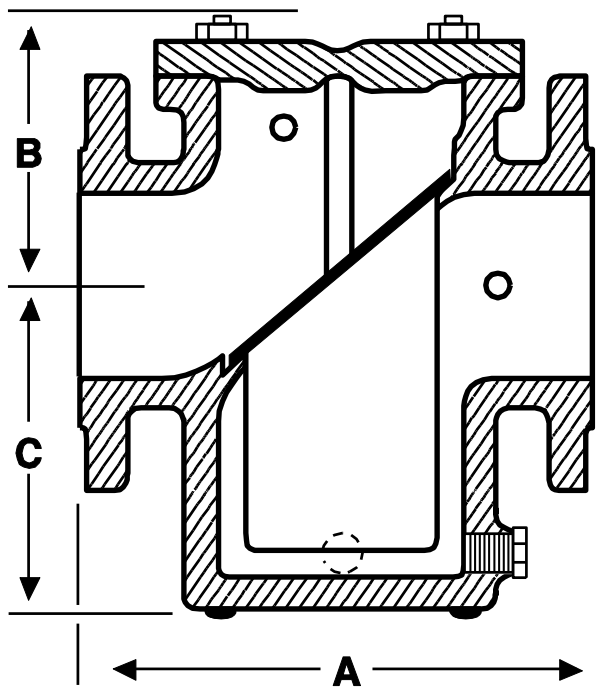

DESCRIPTION	MATERIAL
BODY	ASTM A352 GR. LCC
COVER	ASTM A352 GR. LCC
STUD	ASTM A320 GR. L7M
NUT	ASTM A194 GR. L7M
GASKET	NON ASBESTOS
BASKET	304 SS 1/8 PERF

TEMPERATURE		WORKING PRESSURE	
C	F	kPa	P.S.I.
-45 to 38	-50 to 100	5170	750
95	200	5170	750
150	300	5022	730
200	400	4850	705
260	500	4575	665

NOTE 2" TO 4" DRAIN IS ON SIDE

FLANGES ARE IN ACCORDANCE WITH ANSI B16.5

ALL STRAINERS ARE INDIVIDUALLY HYDROSTATICALLY TESTED TO ANSI B16.5

SIZE		DIMENSIONS						DRAIN		GUAGE CONN		NET WEIGHT	
		A		B		C							
mm	in.	mm	in.	mm	in.	mm	in.	mm	in.	mm	in.	Kg	Lbs
50	2	222	8 3/4	152	6	114	4 1/2	25	1	15	1/2	19.5	43
80	3	242	9 9/16	152	6	139	5 1/2	25	1	15	1/2	28.6	63
100	4	298	11 3/4	177	7	203	8	25	1	15	1/2	48.6	107
150	6	374	14 3/4	196	7 3/4	323	12 3/4	40	1 1/2	15	1/2	95	210
200	8	460	18 1/8	216	9 1/4	384	15 1/8	40	1 1/2	15	1/2	143	315

BOTTOM OF COVER IS CONVEX SO THAT LIQUID LEVEL IS BELOW TOP OF BODY.
THIS WILL HELP PREVENT SPILLAGE WHEN BASKET IS REMOVED.

ALTA	MODEL BFS 600 LCC 600# ANSI CARBON STEEL RAISED FACE FLANGED LOW TEMP BASKET STRAINER	DRAWING L93
-------------	--	--------------------

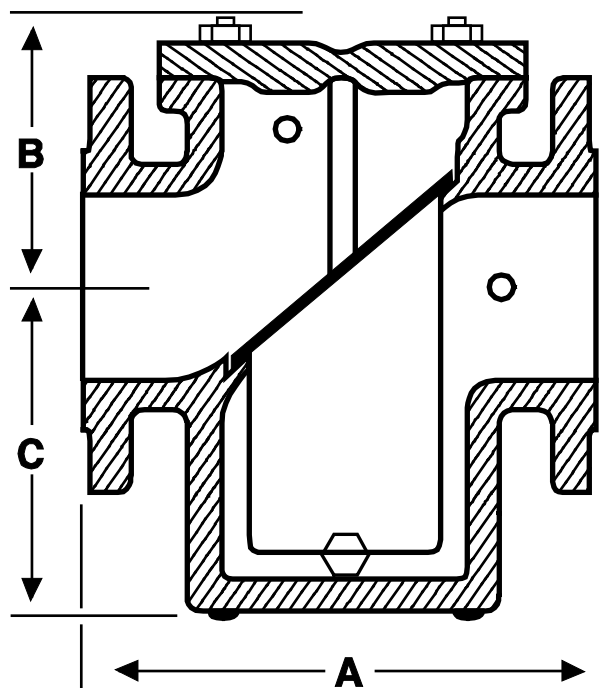

DESCRIPTION	MATERIAL
BODY	ASTM A 352 GR. LCC
COVER	ASTM A 352 GR. LCC
STUD	ASTM A 193 GR. L7M
NUT	ASTM A 194 GR. L7M
GASKET	SPIRAL WOUND SS
SCREEN	304 SS 1/8 PERF

TEMPERATURE		WORKING PRESSURE	
C	F	kPa	P.S.I.
-45 to 38	-50 to 100	10340	1500
95	200	10340	1500
150	300	10010	1455
200	400	9666	1405
260	500	9150	1330

FLANGES ARE IN ACCORDANCE WITH ANSI B16.5

ALL STRAINERS ARE INDIVIDUALLY HYDROSTATICALLY TESTED TO ANSI B16.5

SIZE		DIMENSIONS						DRAIN		GUAGE CONN		NET WEIGHT	
		A		B		C							
mm	in.	mm	in.	mm	in.	mm	in.	mm	in.	mm	in.	Kg	Lbs
25	2	254	10	165	6 1/2	117	4 5/8	25	1	15	1/2	21	47
80	3	320	12 5/8	215	8 1/2	152	6	25	1	15	1/2	43	95
100	4	383	15 1/16	210	8 1/4	200	7 7/8	25	1	15	1/2	79	175

BOTTOM OF COVER IS CONVEX SO THAT LIQUID LEVEL IS BELOW TOP OF BODY.
THIS WILL HELP PREVENT SPILLAGE WHEN BASKET IS REMOVED.

ALTA	MODEL BFS 150 SS 150# ANSI 316SS RAISED FACE FLANGED BASKET STRAINER	DRAWING A57
-------------	---	--------------------

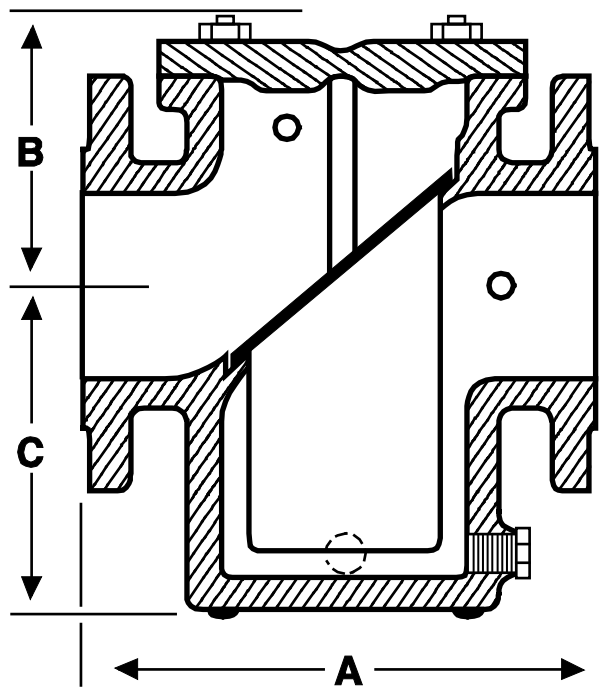

DESCRIPTION	MATERIAL
BODY	ASTM A351 GR. CF8M
COVER	ASTM A351 GR. CF8M
STUD	ASTM A 193 GR. B8
NUT	ASTM A 194 GR. B8
GASKET	TEFLON
BASKET	304 SS 1/8 PERF

TEMPERATURE		WORKING PRESSURE	
C	F	kPa	P.S.I.
-29 to 38	-20 to 100	1896	275
95	200	1655	240
150	300	1480	215
200	400	1345	195

NOTE 2" TO 4" DRAIN IS ON SIDE

FLANGES ARE IN ACCORDANCE WITH ANSI B16.5

ALL STRAINERS ARE INDIVIDUALLY HYDROSTATICALLY TESTED TO ANSI B16.5

SIZE		DIMENSIONS						DRAIN	GUAGE CONN		NET WEIGHT		
		A		B		C							
mm	in.	mm	in.	mm	in.	mm	in.	mm	in.	mm	in.	Kg	Lbs
50	2	203	8 1/8	127	5	115	4 9/16	25	1	15	1/2	14.5	32
80	3	225	8 7/8	146	5 3/4	146	5 3/4	25	1	15	1/2	20.9	46
100	4	285	11 1/4	158	6 1/4	209	8 1/4	25	1	15	1/2	35.4	78
150	6	352	13 7/8	177	7	317	12 1/2	40	1 1/2	15	1/2	68	150
200	8	441	17 3/8	215	8 1/2	406	16	40	1 1/2	15	1/2	110	242
250	10	549	21 5/8	273	10 3/4	445	17 1/2	40	1 1/2	15	1/2	161	355
300	12	635	25	317	12 1/2	558	22	40	1 1/2	15	1/2	280	615

BOTTOM OF COVER IS CONVEX SO THAT LIQUID LEVEL IS BELOW TOP OF BODY.
THIS WILL HELP PREVENT SPILLAGE WHEN BASKET IS REMOVED.

ALTA	MODEL BFS 300 SS 300# ANSI 316SS RAISED FACE FLANGED BASKET STRAINER	DRAWING A58
-------------	---	--------------------

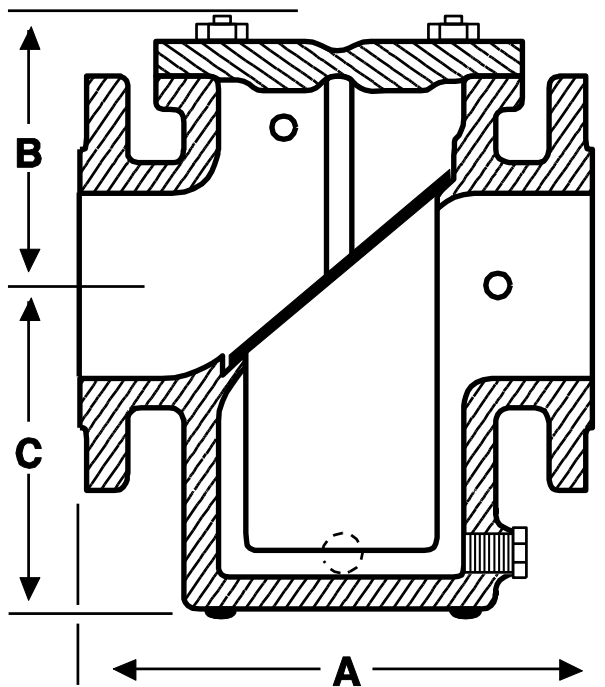

DESCRIPTION	MATERIAL
BODY	ASTM A351 GR. CF8M
COVER	ASTM A351 GR. CF8M
STUD	ASTM A 193 GR. B8
NUT	ASTM A 194 GR. B8
GASKET	TEFLON
BASKET	304 SS 1/8 PERF

TEMPERATURE		WORKING PRESSURE	
C	F	kPa	P.S.I.
-29 to 38	-20 to 100	4965	720
95	200	4275	620
150	300	3860	560
200	400	3550	515

NOTE 2" TO 4" DRAIN IS ON SIDE

FLANGES ARE IN ACCORDANCE WITH ANSI B16.5

ALL STRAINERS ARE INDIVIDUALLY HYDROSTATICALLY TESTED TO ANSI B16.5

SIZE		DIMENSIONS						DRAIN		GUAGE CONN		NET WEIGHT	
		A		B		C							
mm	in.	mm	in.	mm	in.	mm	in.	mm	in.	mm	in.	Kg	Lbs
50	2	222	8 3/4	152	6	114	4 1/2	25	1	15	1/2	19.5	43
80	3	242	9 9/16	152	6	139	5 1/2	25	1	15	1/2	28.6	63
100	4	298	11 3/4	177	7	203	8	25	1	15	1/2	48.6	107
150	6	374	14 3/4	196	7 3/4	323	12 3/4	40	1 1/2	15	1/2	95	210
200	8	460	18 1/8	216	9 1/4	384	15 1/8	40	1 1/2	15	1/2	143	315

BOTTOM OF COVER IS CONVEX SO THAT LIQUID LEVEL IS BELOW TOP OF BODY.
THIS WILL HELP PREVENT SPILLAGE WHEN BASKET IS REMOVED.

ALTA	MODEL BFS 600 600# ANSI STAINLESS STEEL RAISED FACE FLANGED BASKET STRAINER	DRAWING A59
-------------	--	--------------------

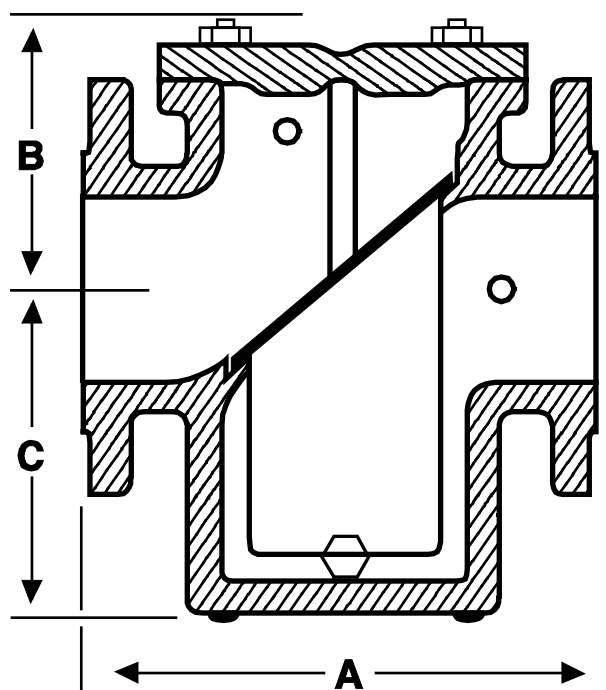

DESCRIPTION	MATERIAL
BODY	ASTM A351 GR. CF8M
COVER	ASTM A351 GR. CF8M
STUD	ASTM A 193 GR. B8
NUT	ASTM A 194 GR. B8
GASKET	SPIRAL WOUND
BASKET	304 SS 1/8 PERF

TEMPERATURE		WORKING PRESSURE	
C	F	kPa	P.S.I.
-29 to 38	-20 to 100	9930	1440
95	200	8550	1240
150	300	7720	1120
200	400	7100	1030

FLANGES ARE IN ACCORDANCE WITH ANSI B16.5

ALL STRAINERS ARE INDIVIDUALLY HYDROSTATICALLY TESTED TO ANSI B16.5

SIZE		DIMENSIONS						DRAIN		GUAGE CONN		NET WEIGHT	
		A		B		C							
mm	in.	mm	in.	mm	in.	mm	in.	mm	in.	mm	in.	Kg	Lbs
25	2	254	10	165	6 1/2	117	4 5/8	25	1	15	1/2	21	47
80	3	320	12 5/8	215	8 1/2	152	6	25	1	15	1/2	43	95
100	4	383	15 1/16	210	8 1/4	200	7 7/8	25	1	15	1/2	79	175

BOTTOM OF COVER IS CONVEX SO THAT LIQUID LEVEL IS BELOW TOP OF BODY.
THIS WILL HELP PREVENT SPILLAGE WHEN BASKET IS REMOVED.

ALTA	MODEL NYF 150 SS 150# ANSI STAINLESS STEEL RAISED FACE FLANGED "Y" STRAINER	DRAWING A 122
-------------	--	----------------------

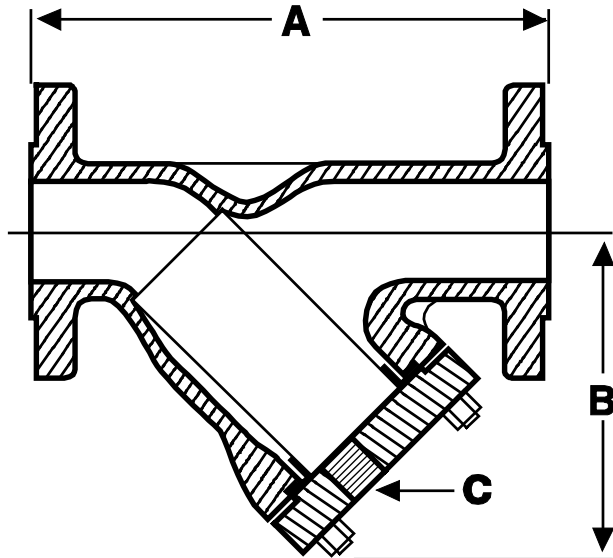

DESCRIPTION	MATERIAL
BODY	ASTM A351 GR CF8M
COVER	ASTM A351 GR CF8M
STUD	ASTM A193 GR. B8
NUT	ASTM A194 GR. B8
GASKET	TEFLON
SCREEN 1" TO 1 1/2"	304 SS 1/32 PERF
SCREEN 2" TO 10"	304 SS 1/8 PERF

TEMPERATURE		WORKING PRESSURE	
C	F	kPa	P.S.I.
-29 to 38	-20 to 100	1896	275
95	200	1655	240
150	300	1480	215
200	400	1345	195

FLANGES ARE IN ACCORDANCE WITH ANSI B16.5

ALL STRAINERS ARE INDIVIDUALLY HYDROSTATICALLY TESTED TO ANSI B16.5

SIZE		DIMENSIONS				SCREEN REMOVAL		NET WEIGHT	
		A		B					
mm	in.	mm	in.	mm	in.	mm	in.	Kg.	Lbs.
25	1	162	6 3/8	127	5	15	1/2	5	11
40	1 1/2	197	7 3/4	133	5 1/4	15	1/2	7.7	17
50	2	200	7 7/8	152	6	20	3/4	10.4	23
80	3	254	10	177	7 1/2	25	1	19	42
100	4	308	12 1/8	279	11	40	1 1/2	33	73
150	6	470	18 1/2	368	14 1/2	50	2	64	140
200	8	549	21 5/8	525	20 5/8	50	2	116	255
250	10	660	26	584	23	50	2	161	355
300	12	762	30	660	26	50	2	209	490

LARGER SIZES AVAILABLE . PLEASE CONTACT US FOR DIMENSIONS.

FEATURES BODY HAS A MACHINED SEAT TO HOLD SCREEN SECURELY.

COVER HAS A MACHINED SCREEN HOLDER TO ALIGN SCREEN DURING INSTALLATION AND TO RETAIN SEDIMENT WHEN COVER IS REMOVED.

BODY IS MACHINED TO HOLD COVER GASKET IN A BLOW-OUT PROOF DESIGN.

FLANGES ARE BACK FACED OR SPOT FACED.

ALTA	MODEL NYF 150 LCC 150# ANSI CARBON STEEL RAISED FACE FLANGED LOW TEMP "Y" STRAINER	DRAWING L210
-------------	---	---------------------

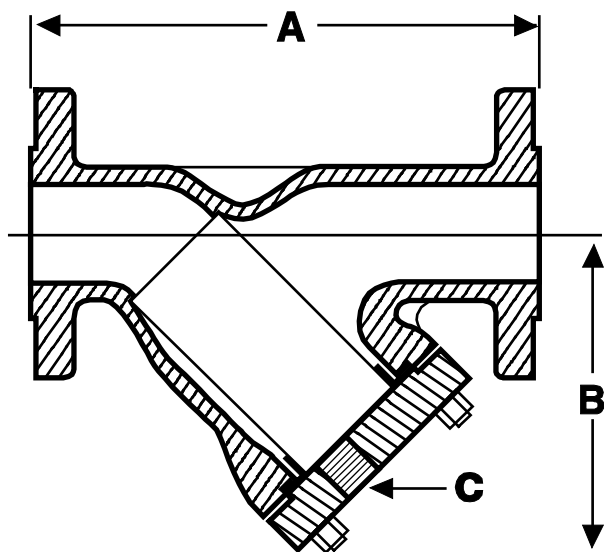

DESCRIPTION	MATERIAL
BODY	ASTM A352 GR. LCC
COVER	ASTM A352 GR. LCC
STUD	ASTM A320 GR. L7M
NUT	ASTM A194 GR. L7M
GASKET	NON ASBESTOS
SCREEN 2" TO 8"	304 SS 1/8 PERF
SCREEN 1" TO 1 1/2"	304 SS 1/32 PERF

TEMPERATURE		WORKING PRESSURE	
C	F	kPa	P.S.I.
-45 to 38	-50 to 100	1980	290
95	200	1788	260
150	300	1582	230
200	400	1376	200
260	500	1169	170

FLANGES ARE IN ACCORDANCE WITH ANSI B16.5

ALL STRAINERS ARE INDIVIDUALLY HYDROSTATICALLY TESTED TO ANSI B16.5

SIZE		DIMENSIONS				SCREEN REMOVAL		NET WEIGHT	
		A		B					
mm	in.	mm	in.	mm	in.	mm	in.	Kg.	Lbs.
25	1	162	6 3/8	127	5	15	1/2	5	11
40	1 1/2	197	7 3/4	133	5 1/4	15	1/2	7.7	17
50	2	200	7 7/8	152	6	20	3/4	10.4	23
80	3	254	10	177	7 1/2	25	1	19	42
100	4	308	12 1/8	279	11	40	1 1/2	33	73
150	6	470	18 1/2	368	14 1/2	50	2	64	140
200	8	549	21 5/8	525	20 5/8	50	2	116	255
250	10	660	26	584	23	50	2	161	355
300	12	762	30	660	26	50	2	209	490

FEATURES BODY HAS A MACHINED SEAT TO HOLD SCREEN SECURELY.

COVER HAS A MACHINED SCREEN HOLDER TO ALIGN SCREEN DURING INSTALLATION AND TO RETAIN SEDIMENT WHEN COVER IS REMOVED.

BODY IS MACHINED TO HOLD COVER GASKET IN A BLOW-OUT PROOF DESIGN.

FLANGES ARE BACK FACED OR SPOT FACED.

ALTA	MODEL NYF 150 150# ANSI CARBON STEEL RAISED FACE FLANGED "Y" STRAINER	DRAWING A 120 REV 1
-------------	--	--

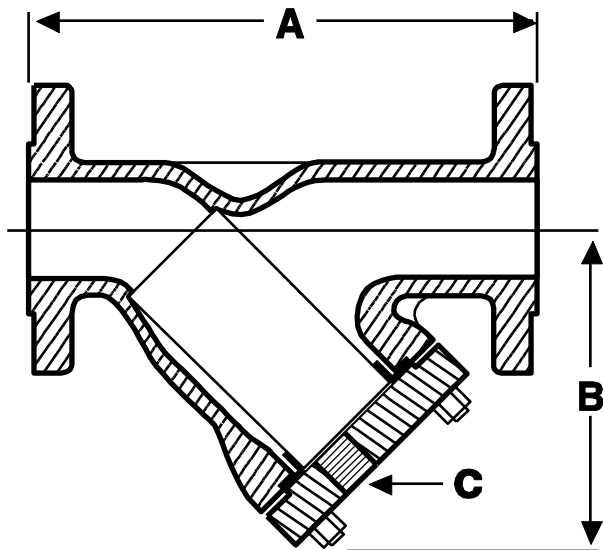

DESCRIPTION	MATERIAL
BODY	ASTM A216 GR. WCB
COVER	ASTM A216 GR. WCB
STUD	ASTM A193 GR. B7
NUT	ASTM A194 GR. 2H
GASKET	NON ASBESTOS
SCREEN 1" TO 1 1/2"	304 SS 1/32 PERF
SCREEN 2" TO 12"	304 SS 1/8 PERF

TEMPERATURE		WORKING PRESSURE	
C	F	kPa	P.S.I.
-29 to 38	-20 to 100	1965	285
95	200	1790	260
150	300	1585	230
200	400	1380	200
260	500	1170	170

FLANGES ARE IN ACCORDANCE WITH ANSI B16.5

ALL STRAINERS ARE INDIVIDUALLY HYDROSTATICALLY TESTED TO ANSI B16.5

SIZE		DIMENSIONS				SCREEN REMOVAL		NET WEIGHT	
		A	B	C					
mm	in.	mm	in.	mm	in.	mm	in.	Kg.	Lbs.
25	1	162	6 3/8	127	5	15	1/2	5	11
40	1 1/2	197	7 3/4	133	5 1/4	15	1/2	7.7	17
50	2	200	7 7/8	152	6	20	3/4	10.4	23
80	3	254	10	177	7 1/2	25	1	19	42
100	4	308	12 1/8	279	11	40	1 1/2	33	73
150	6	470	18 1/2	368	14 1/2	50	2	64	140
200	8	549	21 5/8	525	20 5/8	50	2	116	255
250	10	660	26	584	23	50	2	161	355
300	12	762	30	660	26	50	2	209	490

FEATURES BODY HAS A MACHINED SEAT TO HOLD SCREEN SECURELY.

COVER HAS A MACHINED SCREEN HOLDER TO ALIGN SCREEN DURING INSTALLATION AND TO RETAIN SEDIMENT WHEN COVER IS REMOVED.

BODY IS MACHINED TO HOLD COVER GASKET IN A BLOW-OUT PROOF DESIGN.

FLANGES ARE BACK FACED OR SPOT FACED.

ALTA	MODEL NYF 300 SS 300# ANSI STAINLESS STEEL RAISED FACED FLANGED "Y" STRAINER	DRAWING A 35
-------------	---	---------------------

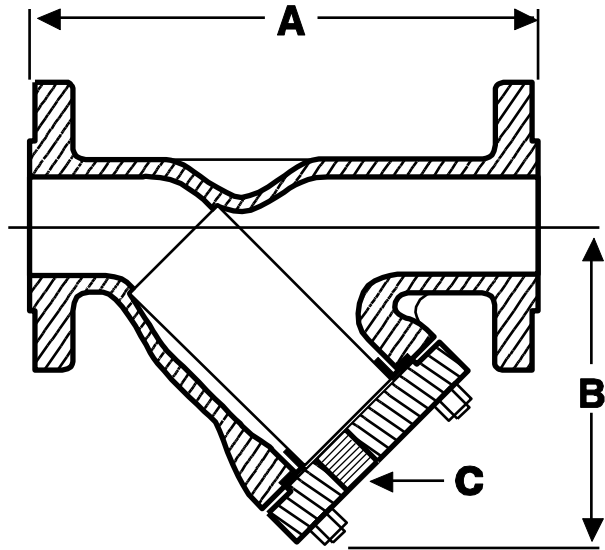

DESCRIPTION	MATERIAL
BODY	ASTM A351 GR. CF8M
COVER	ASTM A351 GR. CF8M
STUD	ASTM A 193 GR. B8
NUT	ASTM A 194 GR. B8
GASKET	TEFLON
SCREEN	304 SS 1/8 PERF

TEMPERATURE		WORKING PRESSURE	
C	F	kPa	P.S.I.
-29 to 38	-20 to 100	4965	720
95	200	4275	620
150	300	3860	560
200	400	3550	515

FLANGES ARE IN ACCORDANCE WITH ANSI B16.5

ALL STRAINERS ARE INDIVIDUALLY HYDROSTATICALLY TESTED TO ANSI B16.5

SIZE		DIMENSIONS						SCREEN REMOVAL		NET WEIGHT	
		A		B		C					
mm	in.	mm	in.	mm	in.	mm	in.	mm	in.	Kg.	Lbs.
50	2	219	8 5/8	158	6 1/4	20	3/4	177	7	12.7	28
80	3	304	12	209	8 1/4	25	1	254	10	25	56
100	4	368	14 1/2	292	11	40	1 1/2	431	17	44	98
150	6	490	19 1/2	355	14	50	2	558	22	79	175
200	8	593	23 3/8	460	18 1/8	50	2	863	34	143	315
250	10	695	27 3/8	584	23	50	2	1066	42	225	495

LARGER SIZES AVAILABLE . PLEASE CONTACT US FOR DIMENSIONS.

FEATURES

BODY HAS A MACHINED SEAT TO HOLD SCREEN SECURELY.

COVER HAS A MACHINED SCREEN HOLDER TO ALIGN SCREEN DURING INSTALLATION AND TO RETAIN SEDIMENT WHEN COVER IS REMOVED.

BODY IS MACHINED TO HOLD COVER GASKET IN A BLOW-OUT PROOF DESIGN.

ALTA

**MODEL NYF 300 LCC
300# ANSI CARBON STEEL
RAISED FACED FLANGED
LOW TEMP "Y" STRAINER**

DRAWING L211

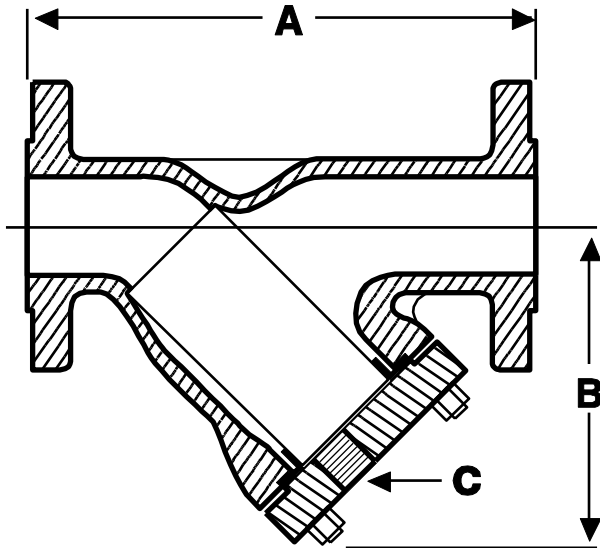

DESCRIPTION	MATERIAL
BODY	ASTM A352 GR. LCC
COVER	ASTM A352 GR. LCC
STUD	ASTM A320 GR. L7M
NUT	ASTM A194 GR. L7M
GASKET	NON ASBESTOS
SCREEN	304 SS 1/8 PERF

TEMPERATURE		WORKING PRESSURE	
C	F	kPa	P.S.I.
-45 to 38	-50 to 100	5170	750
95	200	5170	750
150	300	5022	730
200	400	4850	705
260	500	4575	665

FLANGES ARE IN ACCORDANCE WITH ANSI B16.5

ALL STRAINERS ARE INDIVIDUALLY HYDROSTATICALLY TESTED TO ANSI B16.5

SIZE		DIMENSIONS				SCREEN REMOVAL		NET WEIGHT			
		A		B						C	
mm	in.	mm	in.	mm	in.	mm	in.	Kg.	Lbs.		
50	2	219	8 5/8	158	6 1/4	20	3/4	177	7	12.7	28
80	3	304	12	209	8 1/4	25	1	254	10	25	56
100	4	368	14 1/2	279	11	40	1 1/2	431	17	44	98
150	6	490	19 1/2	355	14	50	2	558	22	79	175
200	8	593	23 3/8	460	18 1/8	50	2	863	34	143	315
250	10	695	27 3/8	584	23	50	2	1066	42	225	495

FEATURES

BODY HAS A MACHINED SEAT TO HOLD SCREEN SECURELY.

COVER HAS A MACHINED SCREEN HOLDER TO ALIGN SCREEN DURING INSTALLATION AND TO RETAIN SEDIMENT WHEN COVER IS REMOVED.

BODY IS MACHINED TO HOLD COVER GASKET IN A BLOW-OUT PROOF DESIGN.

ALTA

MODEL NYF 300 300# ANSI CARBON STEEL RAISED FACED FLANGED "Y" STRAINER

DRAWING A34

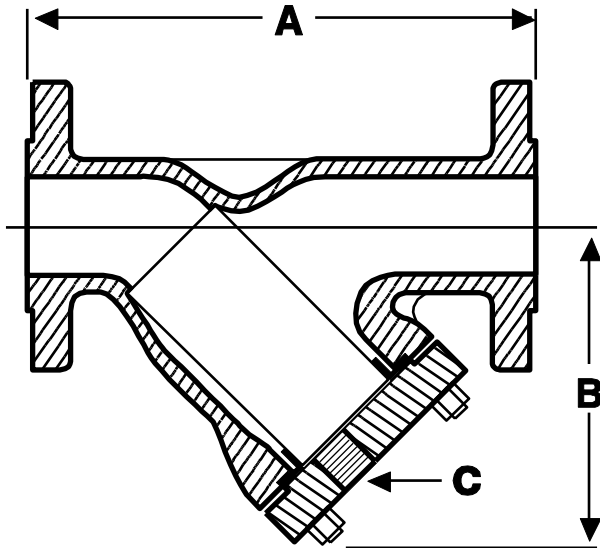

DESCRIPTION	MATERIAL
BODY	ASTM A216 GR. WCB
COVER	ASTM A216 GR. WCB
STUD	ASTM A193 GR. B7
NUT	ASTM A194 GR. 2H
GASKET	NON ASBESTOS
SCREEN	304 SS 1/8 PERF

TEMPERATURE		WORKING PRESSURE	
C	F	kPa	P.S.I.
-29 to 38	-20 to 100	5100	740
95	200	4655	675
150	300	4515	655
200	400	4380	635
260	500	4135	600

FLANGES ARE IN ACCORDANCE WITH ANSI B16.5

ALL STRAINERS ARE INDIVIDUALLY HYDROSTATICALLY TESTED TO ANSI B16.5

SIZE		DIMENSIONS						SCREEN REMOVAL		NET WEIGHT	
		A		B		C					
mm	in.	mm	in.	mm	in.	mm	in.	mm	in.	Kg.	Lbs.
50	2	219	8 5/8	158	6 1/4	20	3/4	177	7	12.7	28
80	3	304	12	209	8 1/4	25	1	254	10	25	56
100	4	368	14 1/2	279	11	40	1 1/2	431	17	44	98
150	6	490	19 1/2	355	14	50	2	558	22	79	175
200	8	593	23 3/8	460	18 1/8	50	2	863	34	143	315
250	10	695	27 3/8	584	23	50	2	1066	42	225	495

LARGER SIZES AVAILABLE . PLEASE CONTACT US FOR DIMENSIONS.

FEATURES

BODY HAS A MACHINED SEAT TO HOLD SCREEN SECURELY.

COVER HAS A MACHINED SCREEN HOLDER TO ALIGN SCREEN DURING INSTALLATION AND TO RETAIN SEDIMENT WHEN COVER IS REMOVED.

BODY IS MACHINED TO HOLD COVER GASKET IN A BLOW-OUT PROOF DESIGN.

ALTA	MODEL YF 600 SS 600# ANSI STAINLESS STEEL RAISED FACE FLANGED "Y" STRAINER	DRAWING A 42
-------------	---	---------------------

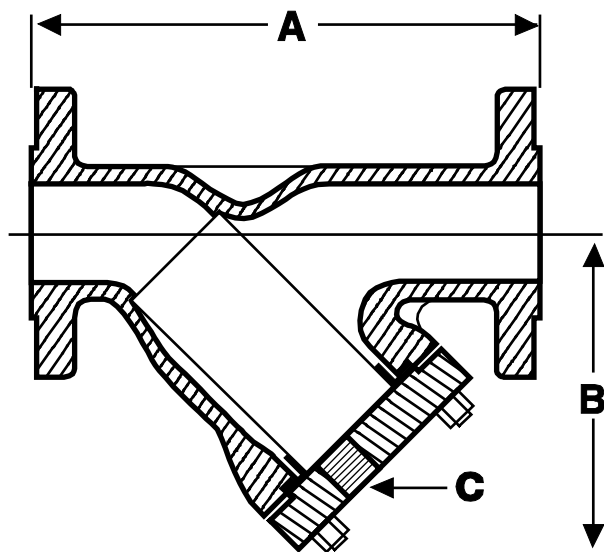

DESCRIPTION	MATERIAL
BODY	ASTM A351 GR. CF8M
COVER	ASTM A351 GR. CF8M
STUD	ASTM A 193 GR. B8
NUT	ASTM A 194 GR. B8
GASKET	SPIRAL WOUND SS
SCREEN 1" TO 1 1/2"	304 SS 1/32 PERF
SCREEN 2" TO 6"	304 SS 1/8 PERF

TEMPERATURE		WORKING PRESSURE	
C	F	kPa	P.S.I.
-29 to 38	-20 to 100	9930	1440
95	200	8550	1240
150	300	7720	1120
200	400	7100	1030

FLANGES ARE IN ACCORDANCE WITH ANSI B16.5

ALL STRAINERS ARE INDIVIDUALLY HYDROSTATICALLY TESTED TO ANSI B16.5

SIZE		DIMENSIONS						SCREEN REMOVAL		NET WEIGHT	
		A		B		C					
mm	in.	mm	in.	mm	in.	mm	in.	mm	in.	Kg.	Lbs.
25	1	213	8 3/8	127	5	15	1/2	140	5 1/2	7.2	16
40	1 1/2	250	9 7/8	152	6	15	1/2	178	7	11	24
50	2	282	11 1/8	171	6 3/4	20	3/4	203	8	21	47
80	3	342	13 3/8	241	9 1/2	25	1	279	11	40	89
100	4	458	18	292	11 1/2	40	1 1/2	355	14	84	186
150	6	595	23 3/8	440	17 3/8	50	2	650	25	155	340
200	8	674	26 9/16	482	19	50	2	736	29	220	485

LARGER SIZES AVAILABLE . PLEASE CONTACT US FOR DIMENSIONS.

FEATURES

BODY HAS A MACHINED SEAT TO HOLD SCREEN SECURELY.

COVER HAS A MACHINED SCREEN HOLDER TO ALIGN SCREEN DURING INSTALLATION AND TO RETAIN SEDIMENT WHEN COVER IS REMOVED.

BODY IS MACHINED TO HOLD COVER GASKET IN A BLOW-OUT PROOF DESIGN.

ALTA	MODEL YF 600 LCC 600# ANSI CARBON STEEL RAISED FACE FLANGED LOW TEMP "Y" STRAINER	DRAWING L212
-------------	--	---------------------

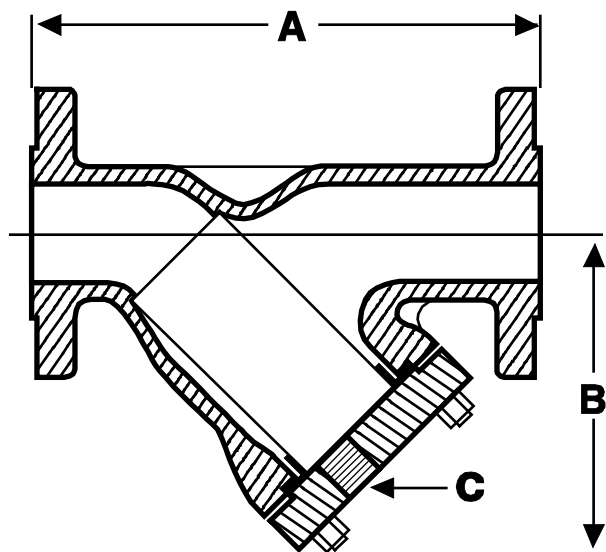

DESCRIPTION	MATERIAL
BODY	ASTM A352 GR. LCC
COVER	ASTM A352 GR. LCC
STUD	ASTM A320 GR. L7M
NUT	ASTM A194 GR. L7M
GASKET	SPIRAL WOUND SS
SCREEN	304 SS 1/8 PERF

TEMPERATURE		WORKING PRESSURE	
C	F	kPa	P.S.I.
-45 to 38	-50 to 100	10340	1500
95	200	10340	1500
150	300	10010	1455
200	400	9666	1405
260	500	9150	1330

FLANGES ARE IN ACCORDANCE WITH ANSI B16.5

ALL STRAINERS ARE INDIVIDUALLY HYDROSTATICALLY TESTED TO ANSI B16.5

SIZE		DIMENSIONS						SCREEN REMOVAL		NET WEIGHT	
		A		B		C					
mm	in.	mm	in.	mm	in.	mm	in.	mm	in.	Kg.	Lbs.
25	1	213	8 3/8	127	5	15	1/2	140	5 1/2	7.2	16
40	1 1/2	250	9 7/8	152	6	15	1/2	178	7	11	24
50	2	282	11 1/8	171	6 3/4	20	3/4	203	8	21	47
80	3	342	13 3/8	241	9 1/2	25	1	279	11	40	89
100	4	458	18	292	11 1/2	40	1 1/2	355	14	84	186
150	6	595	23 3/8	440	17 3/8	50	2	650	25	155	340
200	8	674	26 9/16	482	19	50	2	736	29	220	485

FEATURES

BODY HAS A MACHINED SEAT TO HOLD SCREEN SECURELY.

COVER HAS A MACHINED SCREEN HOLDER TO ALIGN SCREEN DURING INSTALLATION AND TO RETAIN SEDIMENT WHEN COVER IS REMOVED.

BODY IS MACHINED TO HOLD COVER GASKET IN A BLOW-OUT PROOF DESIGN.

ALTA	MODEL YF 600 600# ANSI CARBON STEEL RAISED FACE FLANGED "Y" STRAINER	DRAWING A 40
-------------	---	---------------------

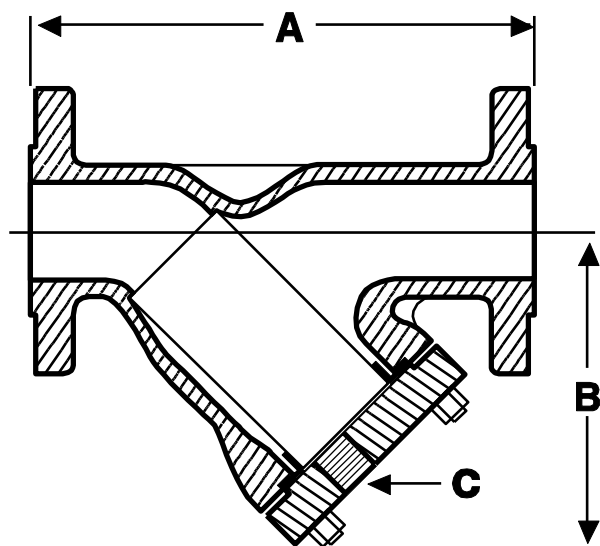

DESCRIPTION	MATERIAL
BODY	ASTM A216 GR. WCB
COVER	ASTM A216 GR. WCB
STUD	ASTM A193 GR. B7
NUT	ASTM A194 GR. 2H
GASKET	SPIRAL WOUND SS
SCREEN 1" TO 1 1/2"	304 SS 1/32 PERF
SCREEN 2" TO 6"	304 SS 1/8 PERF

TEMPERATURE		WORKING PRESSURE	
C	F	kPa	P.S.I.
-29 to 38	-20 to 100	10200	1480
95	200	9300	1350
150	300	9060	1315
200	400	8750	1270
260	500	8275	1200

FLANGES ARE IN ACCORDANCE WITH ANSI B16.5

ALL STRAINERS ARE INDIVIDUALLY HYDROSTATICALLY TESTED TO ANSI B16.5

SIZE		DIMENSIONS						SCREEN REMOVAL		NET WEIGHT	
		A		B		C					
mm	in.	mm	in.	mm	in.	mm	in.	mm	in.	Kg.	Lbs.
25	1	213	8 3/8	127	5	15	1/2	140	5 1/2	7.2	16
40	1 1/2	250	9 7/8	152	6	15	1/2	178	7	11	24
50	2	282	11 1/8	171	6 3/4	20	3/4	203	8	21	47
80	3	342	13 3/8	241	9 1/2	25	1	279	11	40	89
100	4	458	18	292	11 1/2	40	1 1/2	355	14	84	186
150	6	595	23 3/8	440	17 3/8	50	2	650	25	155	340
200	8	674	26 9/16	482	19	50	2	736	29	220	485

LARGER SIZES AVAILABLE . PLEASE CONTACT US FOR DIMENSIONS.

FEATURES

BODY HAS A MACHINED SEAT TO HOLD SCREEN SECURELY.
CUSTOMS SCREENS AVAILABLE UPON CUSTOMER REQUEST.

COVER HAS A MACHINED SCREEN HOLDER TO ALIGN SCREEN DURING
INSTALLATION AND TO RETAIN SEDIMENT WHEN COVER IS REMOVED.

BODY IS MACHINED TO HOLD COVER GASKET IN A BLOW-OUT PROOF DESIGN.

ALTA	MODEL YF 900 SS 900# ANSI STAINLESS STEEL RAISED FACE / RTJ FLANGED "Y" STRAINER	DRAWING A 77
-------------	---	---------------------

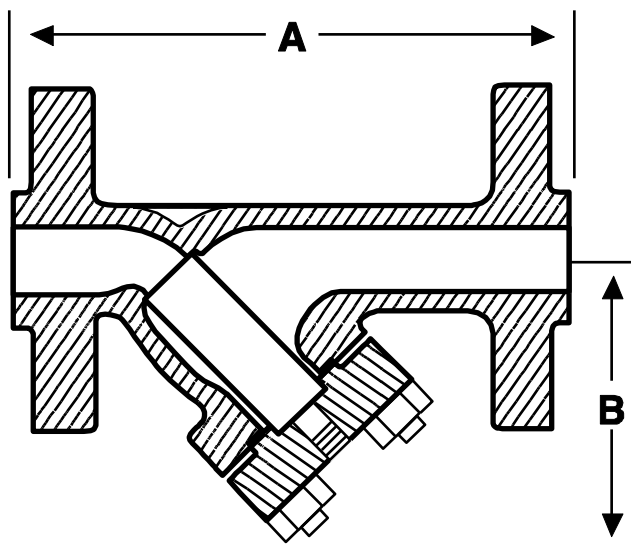

DESCRIPTION	MATERIAL
BODY	ASTM A351 GR. CF8M
COVER	ASTM A351 GR. CF8M
STUD	ASTM A 193 GR. B8
NUT	ASTM A 194 GR. B8
GASKET	SPIRAL WOUND SS
SCREEN	304 SS 1/8 PERF

TEMPERATURE		WORKING PRESSURE	
C	F	kPa	P.S.I.
-29 to 38	-20 to 100	155	2160
95	200	133	1860
150	300	120	1680
200	400	110	1540
260	500	103	1435

FLANGES ARE IN ACCORDANCE WITH ANSI B16.5

ALL STRAINERS ARE INDIVIDUALLY HYDROSTATICALLY TESTED TO ANSI B16.5

SIZE		DIMENSIONS						SCREEN REMOVAL		NET WEIGHT	
		A		B		DRAIN					
mm	in.	mm	in.	mm	in.	mm	in.	mm	in.	Kg.	Lbs.
50	2	349	13 3/4	215	8 1/4	25	1	273	10 3/4	38	84
80	3	464	18 1/2	292	11 1/2	25	1	330	13	61	136
100	4	498	19 5/8	304	12	40	1 1/2	355	14	79	190
150	6	704	27 3/4	457	18	50	2	562	23	234	515
200	8	845	33 1/4	546	21 1/2	50	2	711	28	406	895

LARGER SIZES AVAILABLE . PLEASE CONTACT US FOR DIMENSIONS .

FEATURES

BODY HAS A MACHINED SEAT TO HOLD SCREEN SECURELY.

COVER HAS A MACHINED SCREEN HOLDER TO ALIGN SCREEN DURING INSTALLATION AND TO RETAIN SEDIMENT WHEN COVER IS REMOVED.

BODY IS MACHINED TO HOLD COVER GASKET IN A BLOW-OUT PROOF DESIGN.

FLANGES ARE BACK FACED OR SPOT FACED.

ALTA	MODEL YF 900 LCC 900# ANSI CARBON STEEL RAISED FACE/ RTJ FLANGED LOW TEMP "Y" STRAINER	DRAWING L214
-------------	---	---------------------

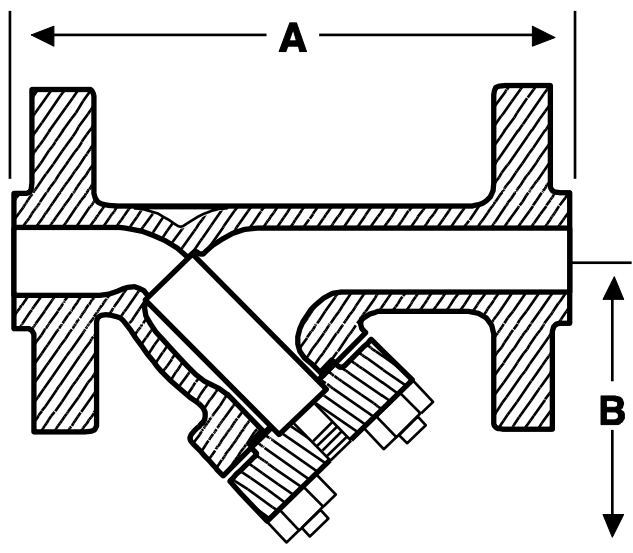

DESCRIPTION	MATERIAL
BODY	ASTM.A352 GR. LCC
COVER	ASTM.A352 GR. LCC
STUD	ASTM A320 GR. L7M
NUT	ASTM A194 GR. L7M
GASKET	SPIRAL WOUND SS
SCREEN	304 SS 1/8 PERF

TEMPERATURE		WORKING PRESSURE	
C	F	kPa	P.S.I.
-45 to 38	-50 to 100	15510	2250
95	200	15510	2250
150	300	15032	2185
200	400	14516	2110
260	500	13725	1995

FLANGES ARE IN ACCORDANCE WITH ANSI B16.5

ALL STRAINERS ARE INDIVIDUALLY HYDROSTATICALLY TESTED TO ANSI B16.5

SIZE		DIMENSIONS						SCREEN REMOVAL		NET WEIGHT	
		A		B		DRAIN					
mm	in.	mm	in.	mm	in.	mm	in.	mm	in.	Kg.	Lbs.
50	2	349	13 3/4	215	8 1/4	25	1	273	10 3/4	38	84
80	3	464	18 1/2	292	11 1/2	25	1	330	13	61	136
100	4	498	19 5/8	304	12	40	1 1/2	355	14	79	190
150	6	704	27 3/4	457	18	50	2	562	23	234	515
200	8	845	33 1/4	546	21 1/2	50	2	711	28	406	895

FEATURES

BODY HAS A MACHINED SEAT TO HOLD SCREEN SECURELY.

COVER HAS A MACHINED SCREEN HOLDER TO ALIGN SCREEN DURING INSTALLATION AND TO RETAIN SEDIMENT WHEN COVER IS REMOVED.

BODY IS MACHINED TO HOLD COVER GASKET IN A BLOW-OUT PROOF DESIGN.

FLANGES ARE BACK FACED OR SPOT FACED.

ALTA	MODEL NYF 900 900# ANSI CARBON STEEL RAISED FACE / RTJ FLANGED "Y" STRAINER	DRAWING A 75
-------------	--	---------------------

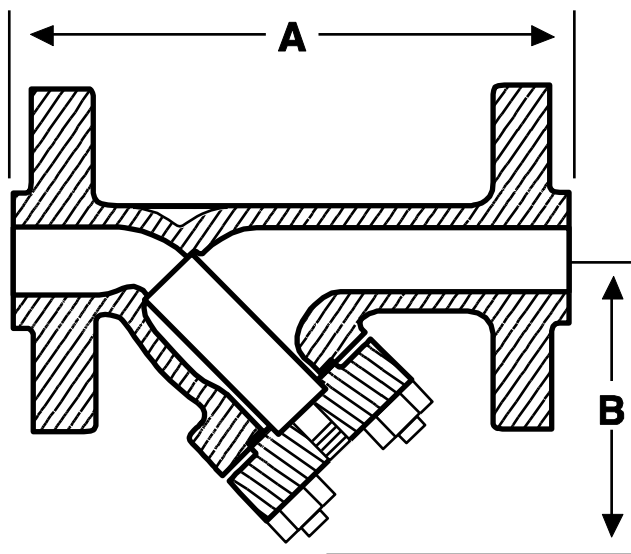

DESCRIPTION	MATERIAL
BODY	ASTM A216 GR. WCB
COVER	ASTM A216 GR. WCB
STUD	ASTM A193 GR. B7
NUT	ASTM A194 GR. 2H
GASKET	SPIRAL WOUND SS
SCREEN	304 SS 1/8 PERF

TEMPERATURE		WORKING PRESSURE	
C	F	kPa	P.S.I.
-29 to 38	-20 to 100	15305	2220
95	200	13960	2025
150	300	13585	1970
200	400	13100	1900
260	500	12375	1795

FLANGES ARE IN ACCORDANCE WITH ANSI B16.5

ALL STRAINERS ARE INDIVIDUALLY HYDROSTATICALLY TESTED TO ANSI B16.5

SIZE		DIMENSIONS						SCREEN REMOVAL		NET WEIGHT	
		A		B		DRAIN					
mm	in.	mm	in.	mm	in.	mm	in.	mm	in.	Kg.	Lbs.
50	2	349	13 3/4	215	8 1/4	25	1	273	10 3/4	38	84
80	3	464	18 1/2	292	11 1/2	25	1	330	13	61	136
100	4	498	19 5/8	304	12	40	1 1/2	355	14	79	190
150	6	704	27 3/4	457	18	50	2	562	23	234	515
200	8	845	33 1/4	546	21 1/2	50	2	711	28	406	895

LARGER SIZES AVAILABLE . PLEASE CONTACT US FOR DIMENSIONS .

FEATURES

BODY HAS A MACHINED SEAT TO HOLD SCREEN SECURELY.

COVER HAS A MACHINED SCREEN HOLDER TO ALIGN SCREEN DURING INSTALLATION AND TO RETAIN SEDIMENT WHEN COVER IS REMOVED.

BODY IS MACHINED TO HOLD COVER GASKET IN A BLOW-OUT PROOF DESIGN.

FLANGES ARE BACK FACED OR SPOT FACED.

ALTA	MODEL YF 1500 SS 1500# ANSI 316SS RAISED FACE / RTJ FLANGED "Y" STRAINER	DRAWING A 74
-------------	---	---------------------

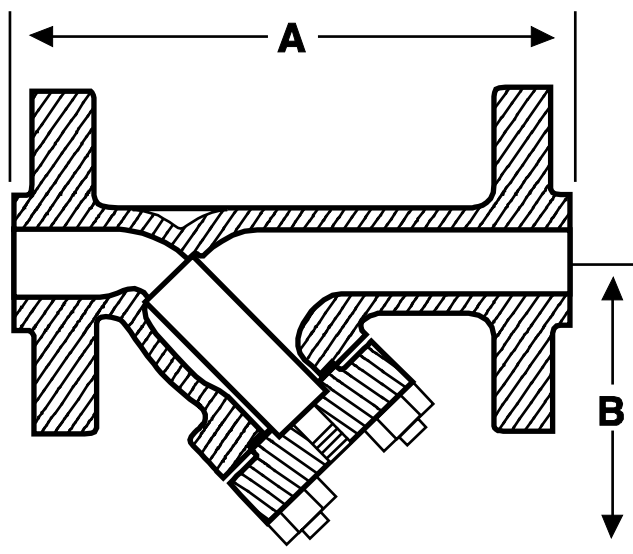

DESCRIPTION	MATERIAL
BODY	ASTM A351 GR. CF8M
COVER	ASTM A351 GR. CF8M
STUD	ASTM A193 GR. B8
NUT	ASTM A194 GR. B8
GASKET	SPIRAL WOUND SS
SCREEN	304 SS 1/8 PERF

TEMPERATURE		WORKING PRESSURE	
C	F	kPa	P.S.I.
-29 to 38	-20 to 100	24822	3600
95	200	21340	3095
150	300	19272	2795
200	400	17720	2560

FLANGES ARE IN ACCORDANCE WITH ANSI B16.5

ALL STRAINERS ARE INDIVIDUALLY HYDROSTATICALLY TESTED TO ANSI B16.5

SIZE		DIMENSIONS				SCREEN REMOVAL		NET WEIGHT	
		A		B					
mm	in.	mm	in.	mm	in.	mm	in.	Kg.	Lbs.
50	2	348	13 3/4	220	8 5/8	25	1	43	96
80	3	479	18 7/8	304	12	25	1	93	205
100	4	590	23 1/4	330	13	40	1 1/2	134	295

LARGER SIZES AVAILABLE . PLEASE CONTACT US FOR DIMENSIONS.

FEATURES

BODY HAS A MACHINED SEAT TO HOLD SCREEN SECURELY.

COVER HAS A MACHINED SCREEN HOLDER TO ALIGN SCREEN DURING INSTALLATION AND TO RETAIN SEDIMENT WHEN COVER IS REMOVED.

BODY IS MACHINED TO HOLD COVER GASKET IN A BLOW-OUT PROOF DESIGN.

FLANGES ARE BACK FACED OR SPOT FACED.

ALTA	MODEL YF 1500 LCC 1500# ANSI CARBON STEEL RAISED FACE / RTJ FLANGED LOW TEMP "Y" STRAINER	DRAWING L215
-------------	--	---------------------

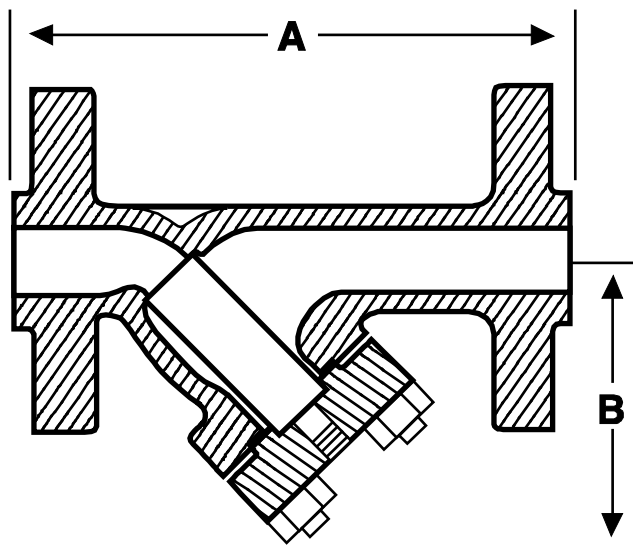

DESCRIPTION	MATERIAL
BODY	ASTM.A352 GR. LCC
COVER	ASTM.A352 GR. LCC
STUD	ASTM A320 GR. L7M
NUT	ASTM A194 GR. L7M
GASKET	SPIRAL WOUND SS
SCREEN	304 SS 1/8 PERF

TEMPERATURE		WORKING PRESSURE	
C	F	kPa	P.S.I.
-45 to 38	-50 to 100	25860	3750
95	200	25860	3750
150	300	25043	3640
200	400	24217	3520
260	500	22876	3325

FLANGES ARE IN ACCORDANCE WITH ANSI B16.5

ALL STRAINERS ARE INDIVIDUALLY HYDROSTATICALLY TESTED TO ANSI B16.5

SIZE		DIMENSIONS						SCREEN REMOVAL		NET WEIGHT	
		A		B		DRAIN					
mm	in.	mm	in.	mm	in.	mm	in.	mm	in.	Kg.	Lbs.
50	2	348	13 3/4	220	8 5/8	25	1	241	9 1/2	43	96
80	3	479	18 7/8	304	12	25	1	343	13 1/2	93	205
100	4	590	23 1/4	330	13	25	1 1/2	381	15	134	295

FEATURES

BODY HAS A MACHINED SEAT TO HOLD SCREEN SECURELY.

COVER HAS A MACHINED SCREEN HOLDER TO ALIGN SCREEN DURING INSTALLATION AND TO RETAIN SEDIMENT WHEN COVER IS REMOVED.

BODY IS MACHINED TO HOLD COVER GASKET IN A BLOW-OUT PROOF DESIGN.

FLANGES ARE BACK FACED OR SPOT FACED.

ALTA	MODEL YF 1500 1500# ANSI CARBON STEEL RAISED FACE / RTJ FLANGED "Y" STRAINER	DRAWING A 70
-------------	---	---------------------

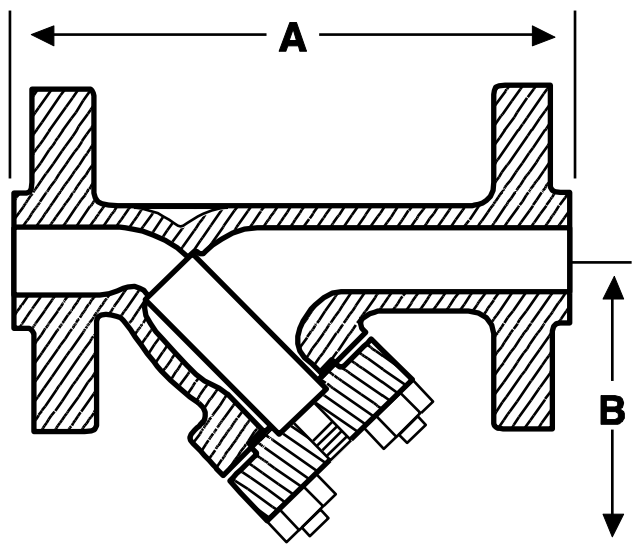

DESCRIPTION	MATERIAL
BODY	ASTM A216 GR. WCB
COVER	ASTM A216 GR. WCB
STUD	ASTM A193 GR. B7
NUT	ASTM A194 GR. 2H
GASKET	SPIRAL WOUND SS
SCREEN	304 SS 1/8 PERF

TEMPERATURE		WORKING PRESSURE	
C	F	kPa	P.S.I.
-29 to 38	-20 to 100	25546	3705
95	200	23701	3375
150	300	22616	3280
200	400	21857	3170
260	500	20651	2995

FLANGES ARE IN ACCORDANCE WITH ANSI B16.5
ALL STRAINERS ARE INDIVIDUALLY HYDROSTATICALLY TESTED TO ANSI B16.5

SIZE		DIMENSIONS				SCREEN		NET			
		A		B		REMOVAL		WEIGHT			
mm	in.	mm	in.	mm	in.	mm	in.	Kg.	Lbs.		
50	2	348	13 3/4	220	8 5/8	25	1	241	9 1/2	43	96
80	3	479	18 7/8	304	12	25	1	343	13 1/2	93	205
100	4	590	23 1/4	330	13	40	1 1/2	381	15	134	295

FEATURES

BODY HAS A MACHINED SEAT TO HOLD SCREEN SECURELY.

COVER HAS A MACHINED SCREEN HOLDER TO ALIGN SCREEN DURING INSTALLATION AND TO RETAIN SEDIMENT WHEN COVER IS REMOVED.

BODY IS MACHINED TO HOLD COVER GASKET IN A BLOW-OUT PROOF DESIGN.

FLANGES ARE BACK FACED OR SPOT FACED.

ALTA	MODEL YF 2500 LCC 2500# ANSI CARBON STEEL RAISED FACE / RTJ FLANGED LOW TEMP "Y" STRAINER	DRAWING L206
-------------	--	---------------------

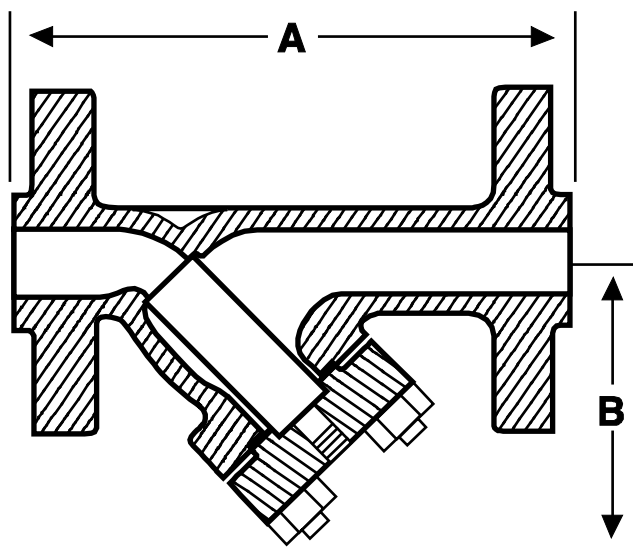

DESCRIPTION	MATERIAL
BODY	ASTM.A352 GR. LCC
COVER	ASTM.A352 GR. LCC
STUD	ASTM A320 GR. L7M
NUT	ASTM A194 GR. L7M
GASKET	SPIRAL WOUND SS
SCREEN	304 SS 1/8 PERF

TEMPERATURE		WORKING PRESSURE	
C	F	kPa	P.S.I.
-45 to 38	-50 to 100	43090	6250
95	200	43090	6250
150	300	41761	6070
200	400	40351	5865
260	500	38115	5540

FLANGES ARE IN ACCORDANCE WITH ANSI B16.5

ALL STRAINERS ARE INDIVIDUALLY HYDROSTATICALLY TESTED TO ANSI B16.5

SIZE		DIMENSIONS						SCREEN REMOVAL		NET WEIGHT	
		A		B		DRAIN					
mm	in.	mm	in.	mm	in.	mm	in.	mm	in.	Kg.	Lbs.
50	2	410	16 1/8	254	10	25	1	330	13	72	160
80	3	572	22 1/2	356	14	25	1	407	16	175	385

FEATURES

BODY HAS A MACHINED SEAT TO HOLD SCREEN SECURELY.

COVER HAS A MACHINED SCREEN HOLDER TO ALIGN SCREEN DURING INSTALLATION AND TO RETAIN SEDIMENT WHEN COVER IS REMOVED.

BODY IS MACHINED TO HOLD COVER GASKET IN A BLOW-OUT PROOF DESIGN.

FLANGES ARE BACK FACED OR SPOT FACED.

ALTA	MODEL YF 2500 2500# ANSI CARBON STEEL RAISED FACE / RTJ FLANGED "Y" STRAINER	DRAWING A 81
-------------	---	---------------------

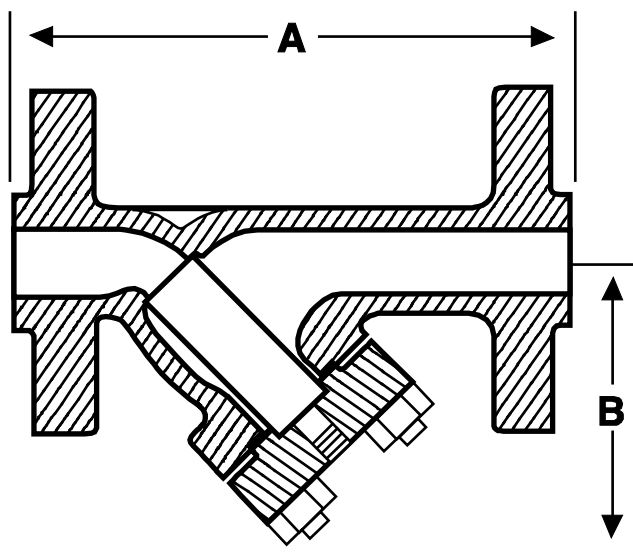

DESCRIPTION	MATERIAL
BODY	ASTM A216 GR. WCB
COVER	ASTM A216 GR. WCB
STUD	ASTM A193 GR. B7
NUT	ASTM A194 GR. 2H
GASKET	SPIRAL WOUND SS
SCREEN	304 SS 1/8 PERF

TEMPERATURE		WORKING PRESSURE	
C	F	kPa	P.S.I.
-29 to 38	-20 to 100	42540	6170

FLANGES ARE IN ACCORDANCE WITH ANSI B16.5

ALL STRAINERS ARE INDIVIDUALLY HYDROSTATICALLY TESTED TO ANSI B16.5

SIZE		DIMENSIONS				SCREEN REMOVAL		NET WEIGHT	
		A		B					
mm	in.	mm	in.	mm	in.	mm	in.	Kg.	Lbs.
50	2	410	16 1/8	254	10	25	1	72	160
80	3	572	22 1/2	356	14	25	1	175	385

FEATURES

BODY HAS A MACHINED SEAT TO HOLD SCREEN SECURELY.

COVER HAS A MACHINED SCREEN HOLDER TO ALIGN SCREEN DURING INSTALLATION AND TO RETAIN SEDIMENT WHEN COVER IS REMOVED.

BODY IS MACHINED TO HOLD COVER GASKET IN A BLOW-OUT PROOF DESIGN.

FLANGES ARE BACK FACED OR SPOT FACED.

ALTA	MODEL YF 2500 SS 2500# ANSI STAINLESS STEEL RAISED FACE / RTJ FLANGED "Y" STRAINER	DRAWING A 84 SSSSS
-------------	---	-------------------------------------

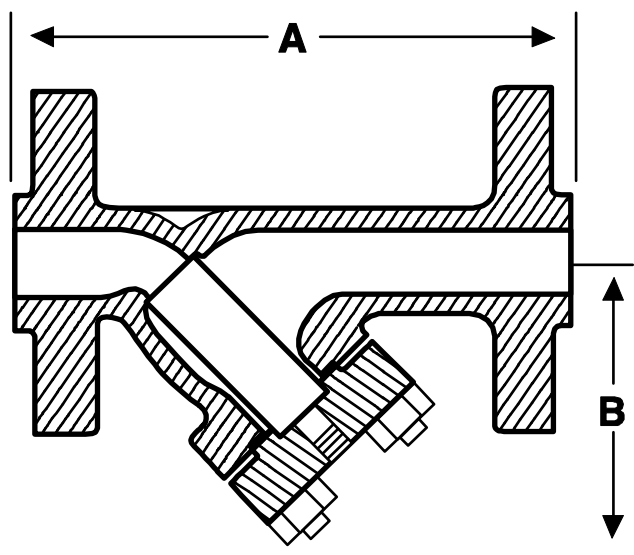

DESCRIPTION	MATERIAL
BODY	ASTM A351 GR. CF8M
COVER	ASTM A351 GR. CF8M
STUD	ASTM A 193 GR. B8
NUT	ASTM A 194 GR. B8
GASKET	SPIRAL WOUND SS
SCREEN	304 SS 1/8 PERF

TEMPERATURE		WORKING PRESSURE	
C	F	kPa	P.S.I.
-29 to 38	-20 to 100	41367	6000

FLANGES ARE IN ACCORDANCE WITH ANSI B16.5

ALL STRAINERS ARE INDIVIDUALLY HYDROSTATICALLY TESTED TO ANSI B16.5

SIZE		DIMENSIONS						SCREEN REMOVAL		NET WEIGHT	
		A		B		DRAIN					
mm	in.	mm	in.	mm	in.	mm	in.	mm	in.	Kg.	Lbs.
50	2	410	16 1/8	254	10	25	1	330	13	72	160
80	3	572	22 1/2	356	14	25	1	407	16	175	385

FEATURES

BODY HAS A MACHINED SEAT TO HOLD SCREEN SECURELY.

COVER HAS A MACHINED SCREEN HOLDER TO ALIGN SCREEN DURING INSTALLATION AND TO RETAIN SEDIMENT WHEN COVER IS REMOVED.

BODY IS MACHINED TO HOLD COVER GASKET IN A BLOW-OUT PROOF DESIGN.

FLANGES ARE BACK FACED OR SPOT FACED.

ALTA	MODEL NYS 600 SS 600# ANSI STAINLESS STEEL SCREWED / SOCKET WELD "Y" STRAINER	DRAWING A113
-------------	--	---------------------

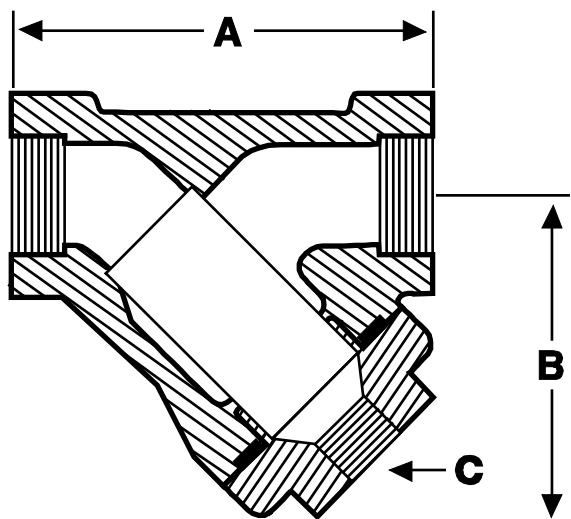

DESCRIPTION	MATERIAL
BODY	ASTM A-351 GR. CF8M
CAP	ASTM A-351 GR. CF8M
GASKET	SPIRAL WOUND SS
SCREEN	304 SS 1/32 PERF

TEMPERATURE		WORKING PRESSURE	
C	F	kPa	P.S.I.
-29 to 38	-20 to 100	9930	1440
95	200	8550	1240
150	300	7720	1120
200	400	7100	1030

ALL STRAINERS ARE INDIVIDUALLY HYDROSTATICALLY TESTED TO ANSI B16.5

SIZE		DIMENSIONS				NET WEIGHT			
		A		B				C	
mm	in.	mm	in.	mm	in.	mm	in.	Kg.	Lbs.
40	1 1/2	142	5 9/16	112	4 3/8	20	3/4	3.6	8
50	2	177	6 15/16	143	5 5/8	25	1	6.8	15

FEATURES

BODY HAS A MACHINED SEAT TO HOLD SCREEN SECURELY.

CAP HAS A MACHINED SCREEN HOLDER TO ALIGN SCREEN DURING INSTALLATION AND TO RETAIN SEDIMENT WHEN CAP IS REMOVED.

BODY IS MACHINED TO HOLD CAP GASKET IN A BLOW-OUT PROOF DESIGN.

ALTA	MODEL NYS 600 LCC 600# ANSI CARBON STEEL SCREWED / SOCKET WELD LOW TEMP "Y" STRAINER	DRAWING L 112
-------------	---	----------------------

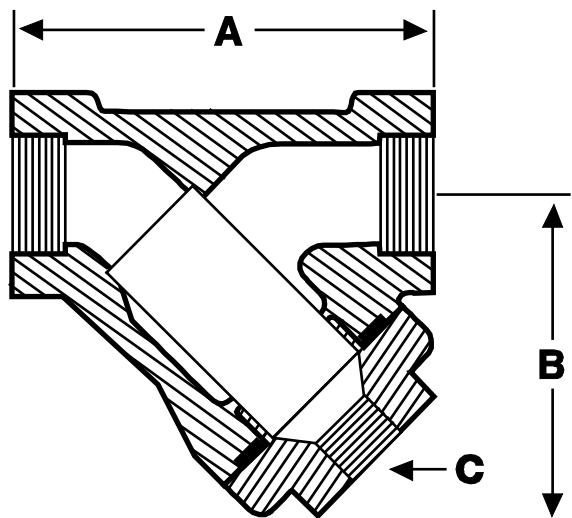

DESCRIPTION	MATERIAL
BODY	ASTM A352 GR. LCC
CAP	ASTM A352 GR. LCC
GASKET	SPIRAL WOUND SS
SCREEN	304 SS 1/32 PERF

TEMPERATURE		WORKING PRESSURE	
C	F	kPa	P.S.I.
-45 to 38	-50 to 100	10340	1500
95	200	10340	1500
150	300	10010	1455
200	400	9666	1405
260	500	9150	1330

ALL STRAINERS ARE INDIVIDUALLY HYDROSTATICALLY TESTED TO ANSI B16.5

SIZE		DIMENSIONS				NET WEIGHT			
		A		B				C	
mm	in.	mm	in.	mm	in.	mm	in.	Kg.	Lbs
40	1 1/2	142	5 9/16	112	4 3/8	20	3/4	3.6	8
50	2	177	6 15/16	143	5 5/8	25	1	6.8	15

FEATURES

BODY HAS A MACHINED SEAT TO HOLD SCREEN SECURELY.

CAP HAS A MACHINED SCREEN HOLDER TO ALIGN SCREEN DURING INSTALLATION AND TO RETAIN SEDIMENT WHEN CAP IS REMOVED.

BODY IS MACHINED TO HOLD CAP GASKET IN A BLOW-OUT PROOF DESIGN.

ALTA	MODEL NYS 600 600# ANSI CARBON STEEL SCREWED / SOCKET WELD "Y" STRAINER	DRAWING A 112
-------------	--	----------------------

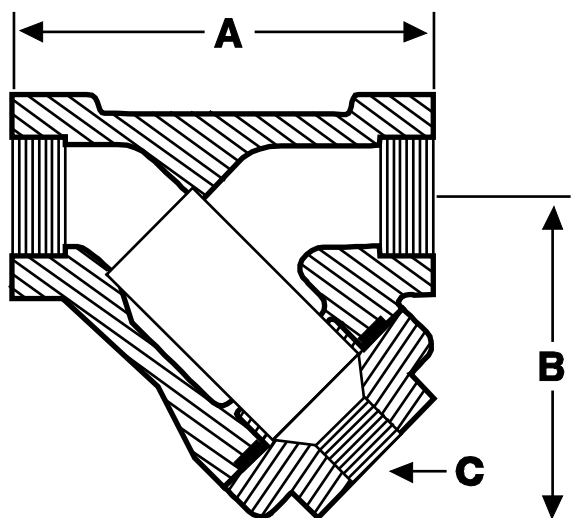

DESCRIPTION	MATERIAL
BODY	ASTM A216 GR. WCB
CAP	ASTM A216 GR. WCB
GASKET	SPIRAL WOUND SS
SCREEN	304 SS 1/32 PERF

TEMPERATURE		WORKING PRESSURE	
C	F	kPa	P.S.I.
-29 to 38	-20 to 100	10200	1480
95	200	9300	1350
150	300	9060	1315
200	400	8750	1270
260	500	8275	1200

ALL STRAINERS ARE INDIVIDUALLY HYDROSTATICALLY TESTED TO ANSI B16.5

SIZE		DIMENSIONS				NET WEIGHT			
		A		B				C	
mm	in.	mm	in.	mm	in.	mm	in.	Kg.	Lbs
40	1 1/2	142	5 9/16	112	4 3/8	20	3/4	3.6	8
50	2	177	6 15/16	143	5 5/8	25	1	6.8	15

FEATURES

BODY HAS A MACHINED SEAT TO HOLD SCREEN SECURELY.

CAP HAS A MACHINED SCREEN HOLDER TO ALIGN SCREEN DURING INSTALLATION AND TO RETAIN SEDIMENT WHEN CAP IS REMOVED.

BODY IS MACHINED TO HOLD CAP GASKET IN A BLOW-OUT PROOF DESIGN.

ALTA	MODEL YS 1500 SS 1500# ANSI STAINLESS STEEL SCREWED / SOCKET WELD "Y" STRAINER	DRAWING A 62
-------------	---	---------------------

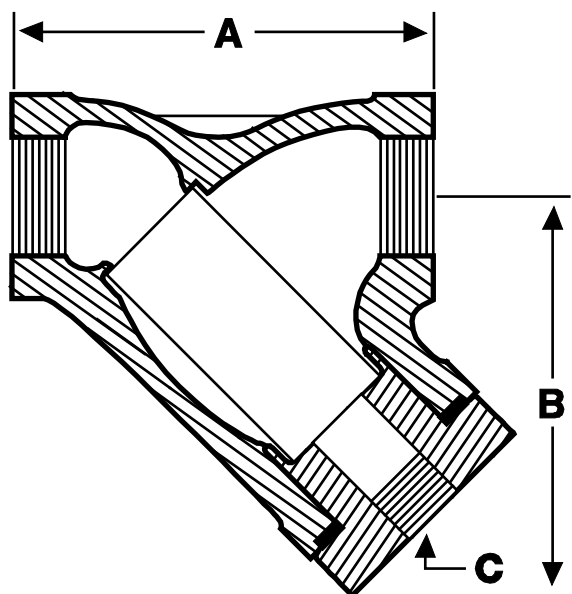

DESCRIPTION	MATERIAL
BODY	ASTM A351 GR. CF8M
CAP	ASTM A351 GR. CF8M
GASKET	SPIRAL WOUND SS
SCREEN	304 SS 1/16 PERF

TEMPERATURE		WORKING PRESSURE	
C	F	kPa	P.S.I.
-29 to 38	-20 to 100	24822	3600
95	200	21340	3095
150	300	19272	2795
200	400	17720	2560

ALL STRAINERS ARE INDIVIDUALLY HYDROSTATICALLY TESTED TO ANSI B16.5

SIZE		DIMENSIONS						SCREEN REMOVAL		NET WEIGHT	
		A		B		C					
mm	in.	mm	in.	mm	in.	mm	in.	mm	in.	Kg.	Lbs.
15	1/2	120	4 3/4	95	3 3/4	10	3/8	114	4 1/2	2	4 1/2
20	3/4	120	4 3/4	95	3 3/4	10	3/8	114	4 1/2	2	4 1/2
25	1	140	5 1/2	120	4 3/4	15	1/2	152	6	3.6	8
40	1 1/2	181	7 1/8	152	6	20	3/4	178	7	7.2	16
50	2	211	8 5/16	170	6 5/8	25	1	241	8	10	22

FEATURES

BODY HAS A MACHINED SEAT TO HOLD SCREEN SECURELY.

CAP HAS A MACHINED SCREEN HOLDER TO ALIGN SCREEN DURING INSTALLATION AND TO RETAIN SEDIMENT WHEN CAP IS REMOVED.

BODY IS MACHINED TO HOLD CAP GASKET IN A BLOW-OUT PROOF DESIGN.

ALTA	MODEL YS1500 LCC 1500# ANSI CARBON STEEL SCREWED / SOCKET WELD LOW TEMP "Y" STRAINER	DRAWING L61
-------------	---	--------------------

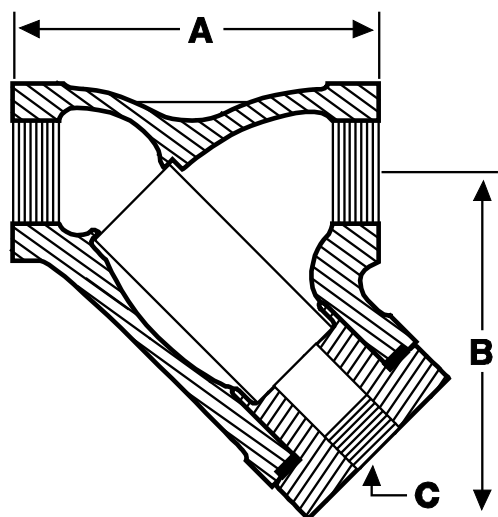

DESCRIPTION	MATERIAL
BODY	ASTM A352 GR. LCC
CAP	ASTM A352 GR. LCC
GASKET	SPIRAL WOUND SS
SCREEN	304 SS 1/16 PERF

TEMPERATURE		WORKING PRESSURE	
C	F	kPa	P.S.I.
-45 to 38	-50 to 100	25860	3750
95	200	25860	3750
150	300	25043	3640
200	400	24217	3520
260	500	22876	3325

ALL STRAINERS ARE INDIVIDUALLY HYDROSTATICALLY TESTED TO ANSI B16.5

SIZE		DIMENSIONS						SCREEN REMOVAL		NET WEIGHT	
		A		B		C					
mm	in.	mm	in.	mm	in.	mm	in.	mm	in.	Kg.	Lbs.
25	1	140	5 1/2	120	4 3/4	15	1/2	152	6	3.6	8
40	1 1/2	181	7 1/8	152	6	20	3/4	178	7	7.2	16
50	2	211	8 5/16	170	6 5/8	25	1	241	8	10	22

FEATURES

BODY HAS A MACHINED SEAT TO HOLD SCREEN SECURELY.

CAP HAS A MACHINED SCREEN HOLDER TO ALIGN SCREEN DURING INSTALLATION AND TO RETAIN SEDIMENT WHEN CAP IS REMOVED.

BODY IS MACHINED TO HOLD CAP GASKET IN A BLOW-OUT PROOF DESIGN.

ALTA	MODEL YS 1500 1500# ANSI CARBON STEEL SCREWED / SOCKET WELD "Y" STRAINER	DRAWING A 61
-------------	---	---------------------

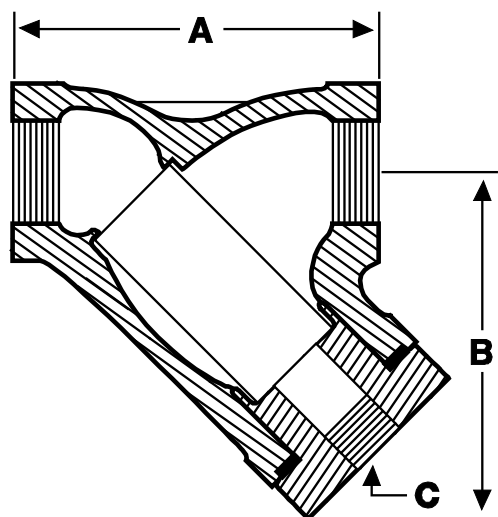

DESCRIPTION	MATERIAL
BODY	ASTM A 216 GR. WCB
CAP	ASTM A 216 GR. WCB
GASKET	SPIRAL WOUND SS
SCREEN	304 SS 1/16 PERF

TEMPERATURE		WORKING PRESSURE	
C	F	kPa	P.S.I.
-29 to 38	-20 to 100	25546	3705
95	200	23701	3375
150	300	22616	3280
200	400	21857	3170
260	500	20651	2995

ALL STRAINERS ARE INDIVIDUALLY HYDROSTATICALLY TESTED TO ANSI B16.5

SIZE		DIMENSIONS						SCREEN REMOVAL		NET WEIGHT	
		A		B		C					
mm	in.	mm	in.	mm	in.	mm	in.	mm	in.	Kg.	Lbs.
15	1/2	120	4 3/4	95	3 3/4	10	3/8	114	4 1/2	2	4 1/2
20	3/4	120	4 3/4	95	3 3/4	10	3/8	114	4 1/2	2	4 1/2
25	1	140	5 1/2	120	4 3/4	15	1/2	152	6	3.6	8
40	1 1/2	181	7 1/8	152	6	20	3/4	178	7	7.2	16
50	2	211	8 5/16	170	6 5/8	25	1	241	8	10	22

FEATURES

BODY HAS A MACHINED SEAT TO HOLD SCREEN SECURELY.

CAP HAS A MACHINED SCREEN HOLDER TO ALIGN SCREEN DURING INSTALLATION AND TO RETAIN SEDIMENT WHEN CAP IS REMOVED.

BODY IS MACHINED TO HOLD CAP GASKET IN A BLOW-OUT PROOF DESIGN.

ALTA	MODEL YS 2500 LCC 2500# ANSI CARBON STEEL SCREWED / SOCKET WELD LOW TEMP "Y" STRAINER	DRAWING L205
-------------	--	---------------------

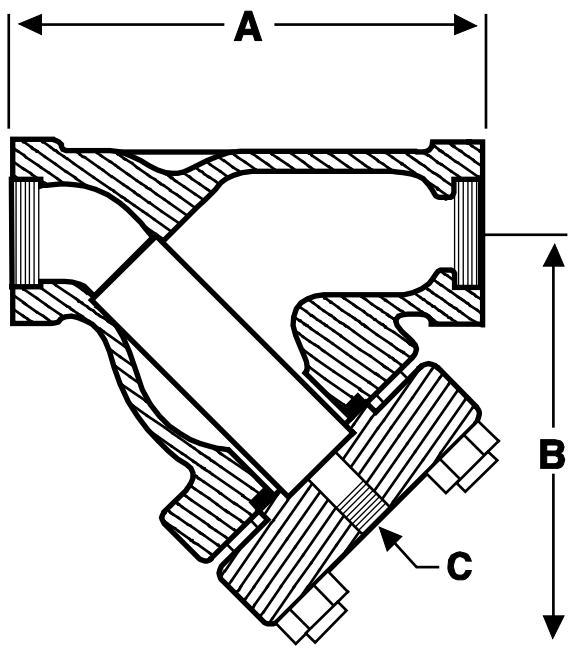

DESCRIPTION	MATERIAL
BODY	ASTM A352 GR. LCC
COVER	ASTM A352 GR. LCC
STUD	ASTM A193 GR. L7M
NUT	ASTM A194 GR. L7M
GASKET	SPIRAL WOUND SS
SCREEN 1 "	304 SS 1/16 PERF
SCREEN 2 "	304 SS 1/8 PERF

TEMPERATURE		WORKING PRESSURE	
C	F	kPa	P.S.I.
-45 to 38	-50 to 100	43090	6250
95	200	43090	6250
150	300	41761	6070
200	400	40351	5865
260	500	38115	5540

ALL STRAINERS ARE INDIVIDUALLY HYDROSTATICALLY TESTED TO ANSI B16.5

SIZE		DIMENSIONS						SCREEN REMOVAL		NET WEIGHT	
		A		B		C					
mm	in.	mm	in.	mm	in.	mm	in.	mm	in.	Kg.	Lbs.
25	1	140	5 1/2	177	7	15	1/2	203	8	10.4	23
50	2	350	13 3/4	238	9 3/8	25	1	330	13	45	100

FEATURES

BODY HAS A MACHINED SEAT TO HOLD SCREEN SECURELY.

COVER HAS A MACHINED SCREEN HOLDER TO ALIGN SCREEN DURING INSTALLATION AND TO RETAIN SEDIMENT WHEN COVER IS REMOVED.

BODY IS MACHINED TO HOLD COVER GASKET IN A BLOW-OUT PROOF DESIGN.

ALTA	MODEL YS 3000 CLASS 3000 CARBON STEEL SCREWED / SOCKET WELD "Y" STRAINER	DRAWING A 101
-------------	---	----------------------

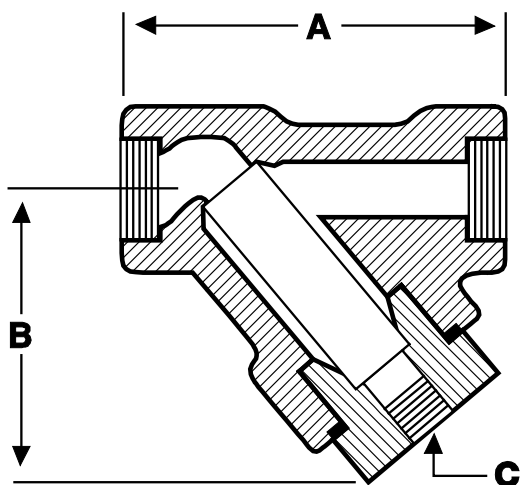

DESCRIPTION	MATERIAL
BODY	ASTM A105 N
CAP	ASTM A105 N
GASKET	SPIRAL WOUND SS
SCREEN	304 SS 1/32 PERF

TEMPERATURE		WORKING PRESSURE	
C	F	kPa	P.S.I.
-29 to 38	-20 to 100	20670	3000
95	200	18844	2735
150	300	18292	2655
200	400	17672	2565
260	500	16708	2425

ALL STRAINERS ARE INDIVIDUALLY HYDROSTATICALLY TESTED TO ANSI B16.5

SIZE		DIMENSIONS						NET WEIGHT	
		A		B		C			
mm	in.	mm	in.	mm	in.	mm	in.	Kg.	Lbs
15	1/2	79	3 1/8	83	3 1/4	10	3/8	.9	2
20	3/4	95	3 3/4	85	3 3/8	10	3/8	1.4	3
25	1	117	4 5/8	89	3 1/2	15	1/2	1.8	4

FEATURES

BODY HAS A MACHINED SEAT TO HOLD SCREEN SECURELY.

CAP HAS A MACHINED SCREEN HOLDER TO ALIGN SCREEN DURING INSTALLATION AND TO RETAIN SEDIMENT WHEN CAP IS REMOVED.

BODY IS MACHINED TO HOLD CAP GASKET IN A BLOW-OUT PROOF DESIGN.

ALTA	MODEL YS 3000SS CLASS 3000 316SS SCREWED / SOCKET WELD "Y" STRAINER	DRAWING A 103
-------------	--	----------------------

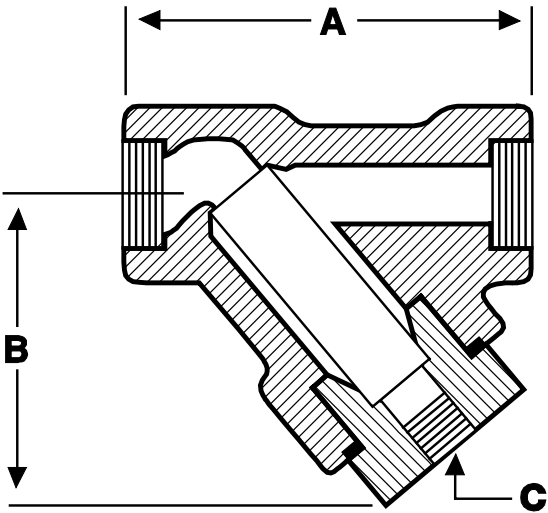

DESCRIPTION	MATERIAL
BODY	ASTM A182 GR F316
CAP	ASTM A182 GR F316
GASKET	SPIRAL WOUND SS
SCREEN	304 SS 1/32 PERF

TEMPERATURE		WORKING PRESSURE	
C	F	kPa	P.S.I.
-29 to 38	-20 to 100	20670	3000

ALL STRAINERS ARE INDIVIDUALLY HYDROSTATICALLY TESTED TO ANSI B16.5

SIZE		DIMENSIONS				NET WEIGHT			
		A		B				C	
mm	in.	mm	in.	mm	in.	mm	in.	Kg.	Lbs
15	1/2	79	3 1/8	83	3 1/4	10	3/8	.9	2
20	3/4	95	3 3/4	85	3 3/8	10	3/8	1.4	3
25	1	117	4 5/8	89	3 1/2	15	1/2	1.8	4

FEATURES

BODY HAS A MACHINED SEAT TO HOLD SCREEN SECURELY.

CAP HAS A MACHINED SCREEN HOLDER TO ALIGN SCREEN DURING INSTALLATION AND TO RETAIN SEDIMENT WHEN CAP IS REMOVED.

BODY IS MACHINED TO HOLD CAP GASKET IN A BLOW-OUT PROOF DESIGN.

ALTA

**MODEL YS 3000 LF2
CLASS 3000 FORGED STEEL
SCREWED / SOCKET WELD
LOW TEMP "Y" STRAINER**

DRAWING L 101

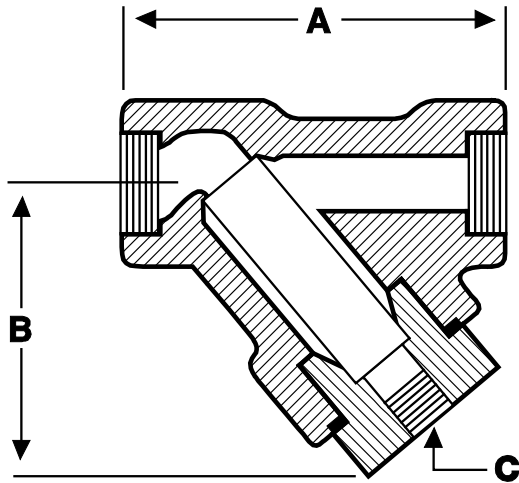

DESCRIPTION	MATERIAL
BODY	ASTM A350 LF2
CAP	ASTM A350 LF2
GASKET	SPIRAL WOUND SS
SCREEN	304 SS 1/32 PERF

TEMPERATURE		WORKING PRESSURE	
C	F	kPa	P.S.I.
-45to 38	-50 to 100	20670	3000
95	200	18844	2735
150	300	18292	2655
200	400	17672	2565
260	500	16708	2425

ALL STRAINERS ARE INDIVIDUALLY HYDROSTATICALLY TESTED TO ANSI B16.5

SIZE		DIMENSIONS						NET WEIGHT	
		A		B		C			
mm	in.	mm	in.	mm	in.	mm	in.	Kg.	Lbs
15	1/2	79	3 1/8	83	3 1/4	10	3/8	.9	2
20	3/4	95	3 3/4	85	3 3/8	10	3/8	1.4	3
25	1	117	4 5/8	89	3 1/2	15	1/2	1.8	4

FEATURES

BODY HAS A MACHINED SEAT TO HOLD SCREEN SECURELY.

CAP HAS A MACHINED SCREEN HOLDER TO ALIGN SCREEN DURING INSTALLATION AND TO RETAIN SEDIMENT WHEN CAP IS REMOVED.

BODY IS MACHINED TO HOLD CAP GASKET IN A BLOW-OUT PROOF DESIGN.

Certificate

Management system as per

ISO 9001:2015

The Certification Body TÜV NORD CERT GmbH, hereby confirms as a result of the audit, assessment and certification decision according to ISO/IEC 17021-1:2015, that the organization

FLOWLINK SYSTEMS PRIVATE LIMITED

**HEAD OFFICE : S.F No.189/1A-1C, Uthupalayam,
Arasur, Coimbatore - 641 407,
Tamil Nadu,
India**



**FLOW LINK
A VOITH COMPANY**

with the locations according to the annex

operates a management system in accordance with the requirements of ISO 9001 : 2015 and will be assessed for conformity within the 3 year term of validity of the certificate.

Scope

Design, Manufacture and Supply of Forged / Cast Valves, Strainers and Machined Castings with Hydro Tested Castings. Manufacture and Supply of Castings in Carbon Steel, Alloy Steel, Stainless Steel and Duplex Stainless Steel.

Certificate Registration No. **44 100 114324**
Audit Report No. **2.5-0069/1999**

Valid from **01.08.2024**
Valid until **02.08.2027**
Initial certification **11.08.2011**



Visit our database to
verify the validity of
this certificate.

Mumbai, **14.07.2024**

Certification Body at TÜV NORD CERT GmbH

TÜV NORD CERT GmbH
Am TÜV 1, 45307,
Essen

www.tuev-nord-cert.com

TÜV*



Deutsche
Akkreditierungsstelle
D-ZM-12007-01-00

TUV INDIA PVT. LTD.
801, Raheja Plaza 1, L.B.S Marg,
Ghatkopar (W) Mumbai - 400 086,
India

www.tuv-nord.com/in

TÜV®

TÜVNORDGROUP